

# CONNECT

9th  
Annual  
May 2-4,





## Welcome to our Keynote Speaker Marcelo Bonta

Philanthropy Northwest Momentum Fellow  
Healthy Environment Program

Marcelo is a trailblazer on diversity, equity, and inclusion issues in the environmental movement. He is currently the Philanthropy Northwest Environmental Fellow at Meyer Memorial Trust, where he has helped develop and implement a new environmental program with equity at its foundation. Marcelo also is the founder of the Center for Diversity and the Environment (CDE) and the Environmental Professionals of Color (EPOC). With CDE, Marcelo worked with over 350 diversity change agents through transformational leadership programs and over 60 organizations and foundations through high impact organizational change work. The Environmental Professionals of Color is a network of over 1500 people of color in over eight chapters across the U.S. In 2008, he co-wrote with Charles Jordan a visionary article, entitled “Diversifying the American Environmental Movement.” His work has been featured in numerous publications, including The New York Times, High Country News, The Oregonian, Prism Magazine and Colors NW. Marcelo serves on the Green 2.0 Advisory Board and Diverse Environmental Leaders Speakers Bureau. In 2016, he was named to the Grist 50 list, a national award given to 50 “innovators, organizers, and visionaries who will lead us toward a more sustainable future, in the coming year (and beyond).”

Marcelo is also a diversity, equity and inclusion (DEI) consultant for environment-focused clients, delivering keynote talks, trainings, and workshops, coaching leaders, and advising projects. Marcelo believes that effective DEI work is more about “how” you do your work rather than “what” you do. In his experience, empathy, compassion and love have been the only consistently successful approaches to achieving DEI.



## THANK YOU to the CONNECT 2017 Planning Team

for their countless hours spent planning and coordinating.

Your efforts are greatly appreciated!

Amanda Schachtschneider, CTUIR  
Kristen Larson, Luckiamute WC  
Michele Levis, West Multnomah SWCD  
Cindy Thieman, Hood River WC  
Lisa Kilders, Clackamas SWCD  
Corrina Chase, Columbia Slough WC  
Angela Previdelli, East Multnomah SWCD  
Debra Bunch, Mid John Day-Bridge Creek WC  
Karen Moon, Harney County WC  
Eric Riley, Partnership for the Umpqua Rivers  
Jason Faucera, Clackamas SWCD

Lisa Mahon, Willowa SWCD  
Shilah Olson, Wasco SWCD  
Eric Nusbaum, ODA  
Cory Owens, NRCS  
Abbie Forrest, Wasco SWCD  
Jerry Nicolescu, OACD  
Judy Marsh, Tualatin SWCD  
Teresa Matteson, Benton SWCD  
Shawn Morford, NOWC  
Pat Fitzgerald, Yamhill SWCD  
Shannon Schmidt, NOWC

# CONNECT Meeting Rooms Pendleton Convention Center

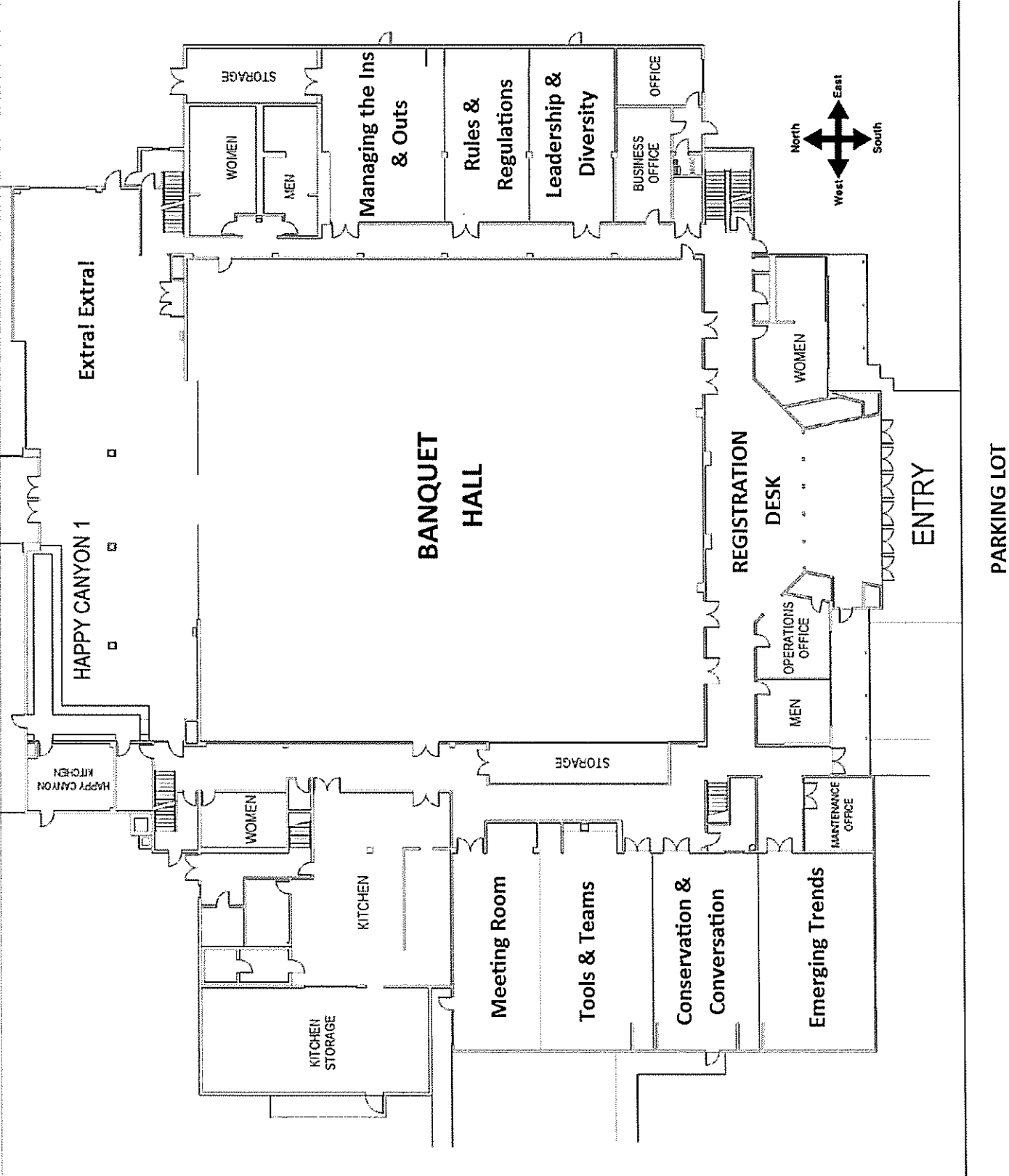

# OCEAN Officers & Representatives

OCEAN Regions



## Officers

President: Jason Faucera, Clackamas SWCD, Western At-Large,  
 Secretary: Lisa Mahon, Wallowa SWCD, Eastern Oregon,  
 Treasurer: Janet Greenup, Morrow SWCD, Eastern At-Large,

## Regional and At-large Representatives

Herb Winters, Wheeler SWCD, Columbia Plateau Representative  
 Rhonda Black, Umpqua SWCD Eastern At-large Representative,  
 Jeremy Baker, East Multnomah SWCD, Western At-large,  
 Walt Barton, Douglas SWCD, Southern Oregon Representative,  
 Bryan Vogt, Monument SWCD, Eastern At-large

## NOWC Board

### Officers

Interim President: Kelly Timchak, Lower Rogue WC  
 Secretary: Kristen Larson, Luckiamute WC  
 Treasurer: Jon Souder, Oregon State Forestry Extension

### Directors

Eric Riley, Partnership for the Umpqua Rivers  
 Karen Moon, Harney County WC  
 Melyssa Graeper, Necanicum WC  
 Cindy Kolomechuk, Sandy River Basin WC  
 Luke Westphal, Greater Yamhill WC  
 Cindy Theiman, Hood River Watershed Group  
 Debra Bunch, Mid John Day-Bridge Creek WC  
 Rob Russell, Tillamook Bay WC

## OACD Board

### Officers

President: Mark Saelens, Lincoln SWCD  
 First Vice President/President Elect: Emily Ackland, Marion SWCD  
 Second Vice President: Pat Fitzgerald, Yamhill SWCD  
 Secretary: Nellie McAdams, East Multnomah SWCD  
 Treasurer: Jerry Ward, Tualatin SWCD  
 Immediate Past President: Jan Lee, Clackamas County SWCD

### Basin Representatives

**North Coast Basin:** Randy Bergman - Columbia SWCD  
**Lower Willamette Basin:** Brian Lightcap - West Multnomah SWCD  
**Upper Willamette Basin:** Mark Saelens - Lincoln SWCD  
**Southwest Oregon Basin:** Barbara Niedermeyer - Jackson SWCD  
**Deschutes/Hood River Basin:** Mel Omeg - Wasco County SWCD  
**High Desert Basin:** Martin Kerns - Klamath SWCD  
**John Day/Umatilla Basin:** Jim McElligott - Morrow SWCD  
**Snake River Basin:** Walt Jury - Keating SWCD  
**OCEAN President:** Jason Faucera - OCEAN

# Table of Contents

Keynote Speaker Introduction.....2

CONNECT 2017 Planning Team Members.....2

Facility Map.....3

OCEAN, NOWC, and OACD Boards.....4

Table of Contents & Welcome .....5

SWCD & Watershed Council Maps.....6-7

Daily Schedules

    Monday .....8

    Tuesday .....9

    Wednesday.....15

    Thursday .....28

Connect at a Glance .....18-19

Speakers .....34

Get to Know Our Sponsors .....17,20,35

## Welcome to Connect

Welcome to CONNECT 2017! We've done things a little different this year in hopes of making a great event even better. Over the past few years OCEAN has partnered with NOWC and OACD to deliver an event that truly lives up to its name. While the sessions we offer are top notch, the value of CONNECT is equally measured by how we are able to network and share our experiences with our peers. With each successive event, we bring in more people, greater conversations and fresh ideas. As a result each conference is richer than the last.

Our expansion continues this year as we present CONNECT as a formal partnership of four organizations committed to community driven conservation in Oregon. Staff and board members of NOWC, OACD, COLT, and OCEAN frequently met this past year, determining as a group how we can more effectively champion the work of our constituents by sharing resources and focusing on outcomes that benefit us all. The format of this year's CONNECT is an extension of that effort, and is really just the beginning of what is planned as the Oregon Conservation Partnership (OrCP) takes shape. We are truly excited about this year's offering and look at it as a beginning of greater things to come.

The CONNECT Planning Team once again came through with a fantastic program. We are grateful for their time and effort to bring this conference to life. We would also like to acknowledge the invaluable financial and technical resources provided by NRCS, ODA, ODF, OWEB, and Meyer Memorial Trust, among other contributing organizations and sponsors. We thank them for their various contributions and continued support.

Learn much, talk lots, and enjoy a great time with people who share your passion for conservation in Oregon. Welcome to Pendleton and CONNECT 2017!

Jason Faucera, President  
Oregon Conservation  
& Education Assistance  
Network (OCEAN)

Shawn Morford, Executive Director  
Network of Oregon Watershed  
Councils (NOWC)

Jerry Nicolescu, Executive Director  
Oregon Association of Conservation  
Districts (OACD)

Kelley Beamer  
Coalition of Oregon  
Land Trusts (COLT)

# Oregon Soil & Water Conservation Districts

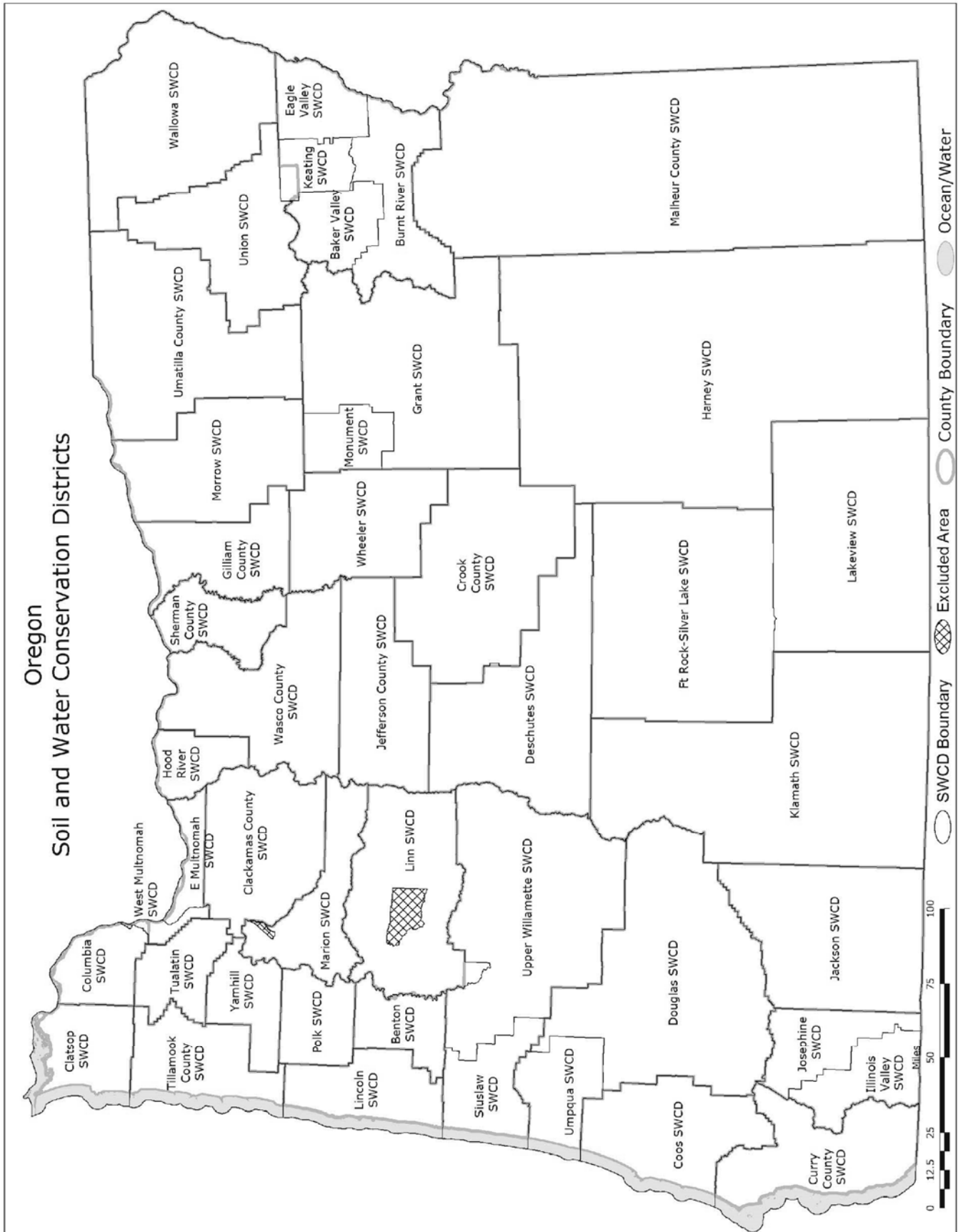

# Oregon Watershed Councils

For the contact information for each watershed council, click inside the watershed council boundary on the map. You may also browse the directory by scrolling directly to the sections below the map.

North Coast Watershed Association

- Necanicum WC
- Lower Columbia WC
- Youngs Bay WC
- Upper Nehalem WC
- Lower Nehalem WC
- Skappawa Bay WC
- Tillamook Bay WC
- Neskowin WC
- Greater Yamhill WC
- Salmon Ditch WC
- MidCoast WC
- Aleas Basin WC\*
- Long Tom WC
- Suslaw WC
- Smith River WC
- Coos Watershed Assoc.
- Coquille Watershed Association
- Port Orford WC
- Lower Rogue WC
- Chiloquin River WC
- Willamette River WC

- Mid-Willamette Watershed Alliance
  - a. Claggett Creek WC
  - b. Pringle Creek WC
  - c. Mill Creek WC
- d. Glenn-Gibson Creek WC
- e. Spring Valley WC
- f. Rockraill WC
- g. Greater Oregon City WC
- h. Johnson Creek WC
- i. Columbia Slough WC
- j. N. Clackamas Urban WC
- k. Lake Oswego WC
- l. Ecola Creek WC
- m. Skipanon WC
- n. Neola/Wickup WC

\*The MidCoast WC is also locally recognized in the Aleas Basin.

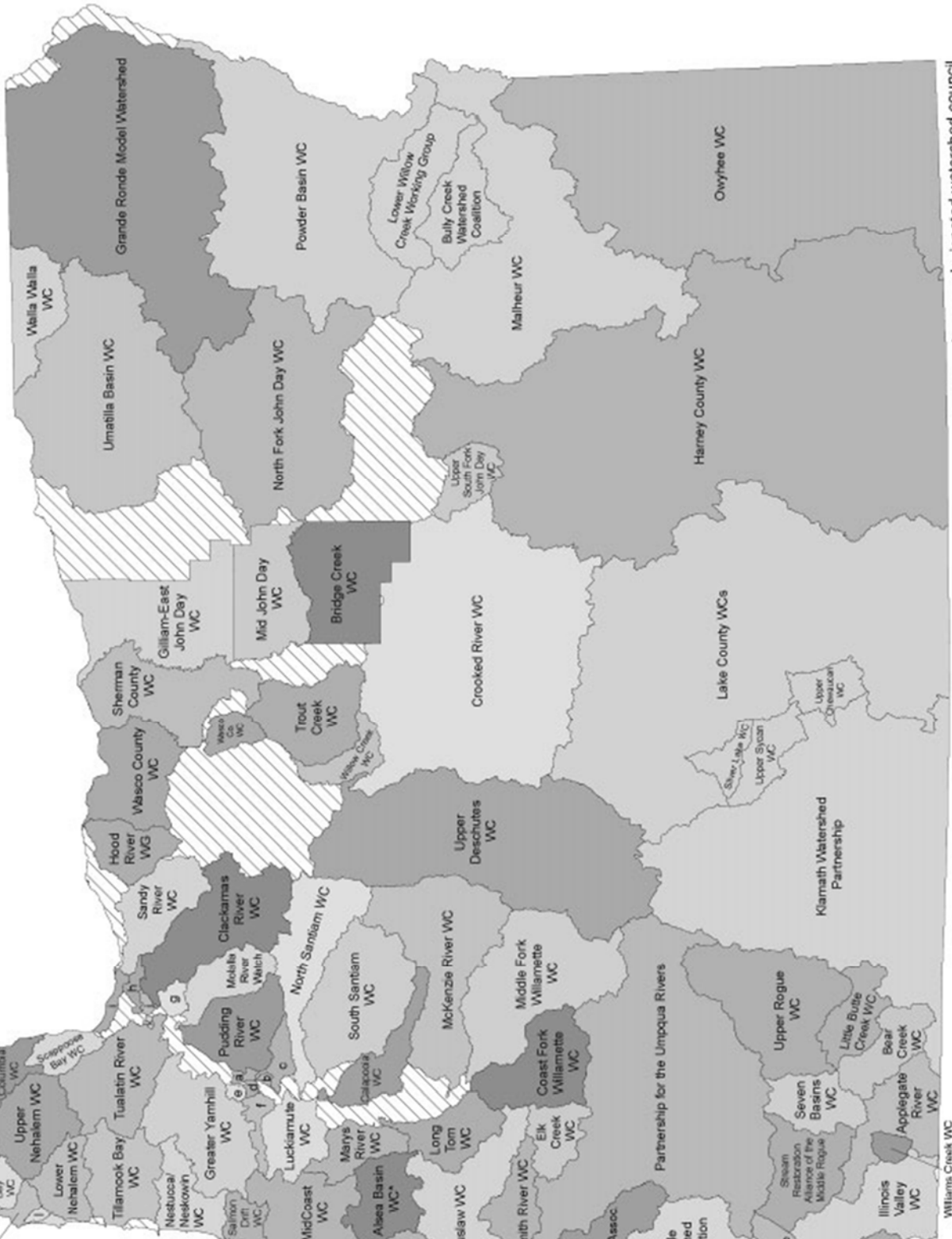

\*Areas with stripes have no designated watershed council.





**7:00AM Breakfast**

-8:30AM Join us in the banquet hall for breakfast.

**7:00AM Registration Desk Open**

-5:00PM The registration desk will be open to help with check-in, door prizes, auction items, and answer your question.

**8:00AM Oregon Association of Conservation Districts Annual Business Meeting**

-Noon

8:00 am	Call to Order	President Saelens
	Welcome	
8:20 am	Roll Call of Districts	Secretary McAdams
8:30 am	Parliamentary Procedure	President Saelens
8:30 am	Business Meeting	
	Minutes 2016	Secretary McAdams
8:45 am	Financial Report	Treasurer Ward
9:15 am	Committee Reports	Committee Chairs
	Membership	
	Strategic Planning	
	Annual Meeting 2018	
	Bylaws	
10:00 am	Break	
10:15 am	Committee Reports cont.	Committee Chairs
	Legislative	
	Basins	
	Personnel	
	Nominations/Elections	
11:00 am	Officer Elections	President Saelens
	Floor Nominations	Chair Boyer
	Certification of Ballots	
	Mail in Ballot Tabulation	
	Floor Elections	
11:45 am	Adjourn	President Boyer

**9:30AM New Employee Orientation**

-11:00AM

**Eric Nusbaum, ODA**

This session is for new employees of Soil and Water Conservation Districts, including Watershed Council employees employed through the SWCD. We will cover the legal responsibilities of being a public employee/official, including Government Ethics, Public Meeting and Record Laws, and the relationship between SWCDs, Watershed Councils, OWEB, ODA, the Agricultural Water Quality Rules, and the Oregon Plan. All this and more in less than two hours! So, yes, there will be lots of handouts to read later. For managers, this session may be of interest to help develop your own new employee orientation.

10:00AM

**Forest Wildfire Restoration Field Trip**

-Noon

**Richard Gardner, CTUIR Silviculture Forester**

The Weigh Station Fire burned in late July - early August 2016. It was about 800 acres in size, and burned with mixed severity and over various terrain, plant associations and, soil types. CTUIR Forestry is responsible for capturing the value of the burned timber, while also managing for Tribal First Foods, and general forest health and sustainability. Major resource concerns for the restoration process were: existing bark beetle infestation in the region, soil organic matter, erosion on steep slopes where vegetation was completely burned, and quickly reestablishing a new cohort of locally adapted seral conifers. The tour will go over the history of the fire, as well as the restoration planning process and implementation.

**Columbia Basin Agricultural Research Center Field Trip****Dr. Stephen Machado**

The Columbia Basin Agricultural Research Center (CBARC) is a branch of the Oregon Agricultural Experiment Station at OSU's College of Agricultural Sciences. Field research emphasizes the production of wheat and rotational crops such as barley, legumes, and canola. Dr. Stephen Machado is a professor of dryland cropping systems and leads long-term research activities at CBARC. The tour will focus on Dr. Machado's work concerning adapting dryland farming practices to a changing climate.

11:00AM

**Soils 101**

-11:30AM

**Cory Owens, NRCS State Soil Scientist**

Unlocking the Secrets in the Soil - a quick introduction to how soil works and the management principles of high functioning soils.

11:30AM

**Lunch & Welcome**

-12:30PM

Join us in the banquet hall for lunch and the CONNECT 2017 opening ceremony with our partners.

1:00PM

**Dancing with J.E.D.I.: Creating a Just, Equitable, Diverse, and Inclusive**

-2:00PM

**Environmental Movement**

**Keynote Speaker: Marcelo Bonta, Philanthropy Northwest Momentum Fellow, Healthy Environment Program**

In this keynote talk, Marcelo Bonta will provide context and inspiration for equity, diversity, and inclusion work, discuss the critical need to diversify, highlight successful efforts and approaches, and share what is needed to create a successful and relevant environmental movement now and far into the future.

Marcelo is a trailblazer on diversity, equity, and inclusion issues in the environmental movement. He is currently the Philanthropy Northwest Environmental Fellow at Meyer Memorial Trust, where he has helped develop and implement a new environmental program with equity at its foundation. Marcelo also is the founder of the Center for Diversity and the Environment (CDE) and the Environmental Professionals of Color (EPOC). With CDE, Marcelo worked with over 350 diversity change agents through transformational leadership programs and over 60 organizations and foundations through high impact organizational change

work. The Environmental Professionals of Color is a network of over 1500 people of color in over eight chapters across the U.S. In 2008, he co-wrote with Charles Jordan a visionary article, entitled “Diversifying the American Environmental Movement.” His work has been featured in numerous publications, including The New York Times, High Country News, The Oregonian, Prism Magazine and Colors NW. Marcelo serves on the Green 2.0 Advisory Board and Diverse Environmental Leaders Speakers Bureau. In 2016, he was named to the Grist 50 list, a national award given to 50 “innovators, organizers, and visionaries who will lead us toward a more sustainable future, in the coming year (and beyond).”

Marcelo is also a diversity, equity and inclusion (DEI) consultant for environment-focused clients, delivering keynote talks, trainings, and workshops, coaching leaders, and advising projects. Marcelo believes that effective DEI work is more about “how” you do your work rather than “what” you do. In his experience, empathy, compassion and love have been the only consistently successful approaches to achieving DEI.

2:15PM

### **Conservation the Good Bugs: Supporting Pest Management While Protecting Natural Resources**

-3:15PM

**Mace Vaughan, Xerces Society**

In this energetic and photo-rich talk, Mace Vaughan will explore the world of beneficial insects and their conservation. He will introduce you to some of the most common and most important predators and parasites of crop pests. He also will discuss their ecology and habitat needs, so that conservation planners will be able to incorporate these needs into their work with landowners.

### **OSU Central Analytical Lab Soil Assessments**

**Shannon Andrews, Oregon State University - Central Analytical Lab**

OSU is pleased to discuss the analytical tests we offer for soil, plant, and soil amendments through the reinvigorated Central Analytical Laboratory. We will also discuss the work that we are doing to build a soil health database, work on a national set of soil health metrics and scoring systems, and work toward meaningful interpretation of soil health data in relation to management practices.

### **Delineating Watersheds Using LiDAR**

**Michael Crabtree, Yamhill SWCD**

I have developed a tool using LiDAR data that will delineate a watershed. I will show how to run the tool and then I will show how to use this information.

### **Contracts A-Z: Demystifying Contracts (2:15-4:30)**

**Eileen G. Eakins, Law Office of Eileen Eakins, LLC**

This session is designed to help non-lawyers understand the essential components of a well-written contract; explain common contract terminology; and help attendees determine the best times to seek legal counsel in preparing and reviewing contracts.

### **TMDL Development and Implementation: Linking Landscape to Water Quality** Gene Foster, DEQ

This session will describe how TMDLs are being developed to better understand the effect implementation of management practices are having on landscape condition and the link to water quality status and trends for meeting TMDL goals.

### **Raising the Bar for Cultural Diversity Inclusion in Ecosystem Restoration: Successful Strategies for Collaborative Engagement with Tribal and Latino Communities (2:15-4:30)**

Marko Bey & Belinda Brown-Lomakatsi Restoration Project, Carl Wilmsen-Northwest Forest Worker Center, Corrina Chase-Columbia Slough Watershed Council, Jim Cathcart-West Multnomah SWCD

In this two hour session, we will hear from leaders at Lomakatsi Restoration Project, Northwest Forest Worker Center, West Multnomah Soil & Water Conservation District and Columbia Slough Watershed Council. The first section of the program we will hear from Marko Bey, Executive Director, and Belinda Brown, Tribal Partnership Manager, from Lomakatsi Restoration Project, who will share examples of successful tribal partnership engagement strategies. Using a collaborative framework and working group model. This collaborative holistic approach is used to facilitate meaningful tribal engagement for ecosystem restoration planning and implementation, and the incorporation of Traditional Ecological Knowledge and ecocultural practices. Next, Carl Wilmsen of the Northwest Forest Worker Center will speak about the interrelationships between healthy forest ecosystems, worker rights, the realities of current working conditions and structural factors affecting the participation of forest workers and harvesters in forest decision making. Last, WMSWCD and CSWC staff will share their resources for internal diversity and inclusion work. Whether you think that equity is only something for Portlanders to worry about, or if you are aware of issues in your community and want to learn more and dive deeper, this session is for you.

### **3:30PM Incorporating Pollinators into Diverse Conservation Practice**

**-4:30PM Mace Vaughan, Xerces Society**

In this presentation, Mace Vaughan will outline how the habitat and conservation needs of pollinators can be incorporated into a wide variety of mostly vegetative conservation practices with the goal of addressing multiple natural resource concerns. He will touch on the wide diversity of pollinators, give an overview of pollinator habitat requirements, and offer suggestions for how pollinator needs can be met through cover cropping, riparian restoration, field borders, conservation buffers, hedgerows, and more.

### **What Every Agronomist Should Know About Biology**

**Jennifer Moore Kucera, NRCS – Soil Health Division**

Soils perform multiple services to help produce high quality food. Working behind the scenes are trillions of tiny organisms that are responsible for all aspects of how soils function. This presentation aims to explain key soil organisms and the critical services they provide. Agricultural practices that enable soil to work at an optimal level will be explored as well as those that limit this ability. By understanding 'who' is in the soil and what they are doing, farming systems can be optimized to not only produce the food and fiber we depend on but also help

improve our air and water quality and be resilient to stresses such as drought, floods, or temperature swings. Come learn about the fascinating life belowground and the trillions of friends you never knew you had!

### **NetMap Analysis and Field Validation for Prioritizing Restoration in the Luckiamute Watershed**

**Jean-Paul Zagarola, Bonneville Environmental Foundation**

The Luckiamute Watershed Council (LWC) is working with TerrainWorks, Inc. to implement watershed restoration analysis using LiDAR combined with the NetMap suite of analysis tools. The analyses can be used to better understand watershed processes and landforms and how historical and current land use activities impact aquatic and riparian resources. The analyses can also be used to prioritize restoration activities at specific locations. NetMap analyses include fish & beaver habitats, floodplains, riparian processes & current conditions, erosion processes, and road erosion potential. The LWC has convened a volunteer Tech Team of local and regional experts to review and interpret results. A fish biologist familiar with the watershed will field validate priority reaches based on model results and Tech Team input. This presentation will provide a brief description of the steps to run NetMap analyses, results, field validation and interpretation, lessons learned and next steps towards project implementation. The project is funded by an OWEB Technical Assistance grant with support from Meyer Memorial Trust, volunteer Tech Team participation, and Bonneville Environmental Foundation.

### **New Tools for Risk Assessment and Place-Based Protection Planning in Groundwater and Surface Water Drinking Water Source**

**Gene Foster and Julie Harvey, Department of Environmental Quality**

As surface water resources are used to capacity and population grows, Oregonians are becoming more dependent on groundwater resources and they expect those resources to remain clean, available and usable. In addition, groundwater in hydraulic connection with surface water can also affect surface water sources and your projects. SWCDs and watershed councils continue to provide extensive technical assistance and outreach to local communities addressing groundwater concerns. In this presentation we will provide an overview of some of the tools being developed to inform community-led discussions on groundwater and surface water protection and restoration. Topics will include screening tools to identify members of the community that own land within the public well recharge zone, a tool to evaluate a soil's intrinsic potential to leach pesticides (and to an extent fertilizers) into public drinking water wells; potential impacts and outreach for septic system owners; and other land management related tools. Come get a first look at these tools and how they can be used to prioritize technical assistance, provide a basis for grants and other project funding, and justify new/renewed water quality monitoring/sampling activities. Information on potential resources and funding sources for addressing these issues will also be provided.

4:45PM

### **OCEAN Annual Meeting**

Join Oregon Conservation Education & Assistance Network for the 2017 Annual Meeting!!! Come hear updates, elect new board members, and see what the future holds for OCEAN.



7:00AM

**Breakfast**

-8:30AM

Join us in the banquet hall for breakfast.

8:00AM

**Registration Desk Open**

-5:00PM

The registration desk will be open to help with check-in and answer your question.

8:30AM

**Targeted Grazing Applied to Reduce Fire Risk in the Sagebrush Steppe**

-9:30AM

**Chris Schachtschneider, OSU Extension Services**

Wildland fires are continuing to threaten western landscapes, especially sagebrush steppe ecosystems. Increases in invasive annual grasses such as cheat grass and medusahead have only escalated the issue, as they ripen early in the season and quickly become ignitable fuel to start and propagate a fire. These are trends we need to stop and to do so, we need to think about alternate ways we can help with fire suppression to add “tools in the tool box.” Cattle are abundant on most western lands and can be converted into a tool to aid in wildfire suppression. As cattle go about their day, they remove, trample, and flatten the very vegetation that becomes fuel in a wildland fire event. This alteration of fuel by cattle can become an asset to fire suppression efforts when creating and maintaining fire breaks. Recent studies have been done in Idaho and Oregon showing that cattle can be utilized to mitigate fire risk through targeted grazing and help protect the sagebrush steppe ecology and diversity.

**Using Market Research to Better Understand Nursery Growers’ Perspectives on Soil Erosion**

**Chelsea White-Brainard and Aaron Guffey, East Multnomah SWCD**

In March 2016 the East Multnomah Soil & Water Conservation District contracted with Pivot Group on a research study to better understand nursery growers’ experience with soil erosion. The study objectives were to 1) better understand the behaviors, values, and needs of our region’s nursery growers regarding soil erosion prevention, and 2) identify what methods and messages will be most effective in motivating this group to partner with Conservation Districts to install erosion prevention practices. Through one-on-one telephone interviews, the Pivot team was able to survey 60 nursery growers. The results of this study will inform our outreach strategy as we design a focused erosion prevention campaign for nurseries.

**Diverse Stakeholders Involved in River Cleanup**

**Cassie Cohen and Art McConville, Portland Harbor Community Coalition**

Presenters will hold an interactive workshop about lessons learned from an ongoing grassroots, coalition effort to influence the decisions around cleaning up the Portland Harbor Superfund Site, a 10-mile stretch of the lower Willamette River. The Portland Harbor Community Coalition (PHCC) is a group of individual community members, community of color organizations, conservation organizations, environmental justice organizations, and Native organizations, all invested in the outcome of the Willamette River’s Superfund site cleanup.

### **A One-Hour Investment in Ethics**

**Eileen G. Eakins, Law Office of Eileen Eakins, LLC**

All local government elected officials, employees, and volunteers are subject to Oregon's Ethics Laws for public officials. Attorney Eileen Eakins will provide a one-hour review of the key points to remember to ensure compliance with ethics requirements.

### **Water Quality as a Planning Tool: Water Quality Status and Trends Analysis Reports**

**Maddee Rubenson-Oregon DEQ Water Quality Analyst, Tonya Dombrowski-Oregon DEQ Basin Coordinator, and Koto Kishida-Oregon DEQ Nonpoint Source Specialist**

DEQ began providing Water Quality Status & Trends Analysis reports to support biennial reviews in late 2016. These reports are specific to local Agricultural Management Areas and compare data to water quality standards, and where appropriate, TMDL allocations. Analyses in the reports use water quality data readily accessible from public databases and available in sufficient quantity to indicate status and trends.

DEQ's water quality analyst and NPS Specialist will present what is in DEQ's Water Quality Status and Trends Analysis reports and how they could be used to support watershed planning efforts.

### **A Tribal First Foods Perspective and Inter-Governmental Relations**

**Eric Quaempts, Confederate Tribes of Umatilla Indian Reservation**

This session will offer insights and information to help districts, councils and land trusts that want to build relationships with Oregon tribes through the eyes of a tribal natural resource leader. The session will offer discussions on the meaning of Government to Government, sovereignty, ceded lands, aboriginal use areas, and First Foods management concepts important to partnership with Oregon's tribes.

### **Using Conservation Easements to Fulfill Conservation Goals (8:30-Noon)**

**Mike Running, Coalition of Oregon Land Trusts**

Conservation easements now protect over 26 million acres of land in the United States. In Oregon, land trusts have protected approximately 140,000 acres of habitat, farms, ranches, and forests with easements. As more SWCDs are looking into holding conservation easements as part of their conservation toolbox, this session will look at easements in-depth and how organizations can employ them effectively, responsibly, and with the assurance that they can help achieve your conservation goals.

Specifically, this session will:

- Provide a brief introduction to easements, including the programs that fund them
- Go through the structure of a typical easement, as well as what makes a "working lands" conservation easements different from habitat-focused easements
- Talk about how to develop a conservation easement program for an organization
- This will include risk management, enforcement, best practices, monitoring of easements, and more
- Present ways to reach out to and speak with landowners about easements
- Review ways SWCDs can and do work with land trusts and conservation easements



helping people  
help **the land**

USDA Natural Resources Conservation Service

# NRCS OREGON

*Conservation Assistance Available*

[www.or.nrcs.usda.gov](http://www.or.nrcs.usda.gov)

USDA is an equal opportunity provider,  
employer, and lender.



CONNECT 2017 AGENDA						
Emerging Trends	Conservation & Conversation	Tools & Teams	Managing the Ins & Outs	Rules & Regulations	Leadership & Diversity	Meeting Room
Monday May 1, 2017						
3:00-5:00 PM						
5:00-7:30 PM					NOWC Board Meeting	
7:30-9:30 PM					OACD Board Meeting	
Registration Desk Open						
Tuesday May 2, 2017						
7:00AM-5:00PM						
7:00 AM-8:30 AM						
8:00 AM						
9:30 AM						
10:00 AM						
11:00 AM						
11:30 AM						
12:15-1:00 PM						
1:00-2:00 PM						
2:15-3:15 PM						
3:30-4:30 PM						
4:45 PM						
5:45 PM - 6:00 PM						
6:00 PM - 6:30 PM						
6:30 PM - 7:30 PM						
Registration Desk Open						
Breakfast						
8:00AM-5:00PM						
7:00 AM - 8:30 AM						
8:30 AM - 9:30 AM						
8:30 AM - 9:30 AM						
Wednesday May 3, 2017						
Registration Desk Open						
Breakfast						
8:00AM-5:00PM						
7:00 AM - 8:30 AM						
8:30 AM - 9:30 AM						
8:30 AM - 9:30 AM						
Dinner						
Meet & Greet with Sponsors						
Raising the Bar for Cultural Diversity Inclusion in Ecosystem Restoration						
TMDL Development and Implementation: Linking Landscape to Water Quality						
New Tools for Risk Assessment and Place-Based Protection Planning in Groundwater and Surface Water Drinking Water Source						
Contracts AZ: Demystifying Contracts						
NetMap Analysis and Field Validation for Prioritizing Restoration in the Luckiamute Watershed						
OSU Central Analytical Lab Soil Assessments						
Delineating Watersheds using LIDAR						
OSU Central Analytical Lab Soil Assessments						
What Every Agronomist Should Know About Biology Jennifer Moore Kucera						
Incorporating Pollinators into Diverse Conservation Practices						
OCEAN Annual Meeting						
NRCS National Planning Certification Partners Q&A						
Using Conservation Easements to Fulfill Conservation Goals						
How to Communicate Effectively to Diverse						
A Tribal First Foods Perspective and Inter-Governmental Relations						
Water Quality as a Planning Tool: Water Quality Status and Trends Analysis Reports						
A One-Hour Investment in Ethics						
Diverse Stakeholders Involved in River Cleanup						
Using Market Research to Better Understand Nursery Growers' Perspectives on Soil Erosion						
Oregon's Land Use						
Targeted Grazing Applied to Reduce Fire Risk in the Sagebrush Steppe						
Organic Livestock and						
Preparing a Communitive						
Oregon's Land Use						
Using Market Research to Better Understand Nursery Growers' Perspectives on Soil Erosion						
Diverse Stakeholders Involved in River Cleanup						
A One-Hour Investment in Ethics						
Water Quality as a Planning Tool: Water Quality Status and Trends Analysis Reports						
How to Communicate Effectively to Diverse						
Using Conservation Easements to Fulfill Conservation Goals						
ONA Office						

TIME	TOPIC	RESOURCES	Public Contracting in Oregon	and Maintenance Across Oregon: An Overview	How to Organize and Run an Effective Tax Levy Campaign
11:00 AM - 12:00 PM	Organic Farming and Water Quality	CREP Effectiveness Monitoring Study Update	The Confluence of Collaboration and Clean Water: How You Can Accomplish More Through Partnerships	Updates from ODF: New Rules for Riparian Protection Standards & Bald Eagles	Starting a Collaborative Effort for Your Community
12:00 PM - 1:30 PM	Riparian Grazing Management With Water Quality Considerations	Writing a Communication/Marketing Plan for your Organization	Introducing Oregon Conservation Strategy.org and ODFW Compass 2.0	IGAs, MOUs, MOAs: The How, Why and When	
1:30 PM - 2:30 PM	Planning for Flood Emergencies: The Levee Perspective	Posts and Press Releases: Successful Writing for the Web	AgBiz Climate Decision Support Tool: Help Producers Understand How Changes in the Climate Will Affect Their Bottom Line	Cultural Resources Protection Regulations with OWEB	Recipe for Effective and Productive Meetings: Easy as Pea Soup
2:45 PM - 3:45 PM	Saving Habitat for Streaked Horned Lark	Recipe for Success: How to Hold a GREAT Event	Collaborative Planning to Project to Oregon's Water Resources Development Program Partners With Oregonians to Meet Water Needs		
4:00 PM - 5:00 PM			Administering Small Grants Round Table		
5:00 PM - 6:00 PM			Sponsor Meet & Greet		
6:00 PM - 7:30 PM			Banquet		

Thursday May 4, 2017					
Registration Desk Open					
Breakfast					
8:00AM-Noon					
7:00 AM - 8:30 AM	Unlocking Carbon Markets for Family Forest Owners: Innovations for Overcoming Transaction Costs in Ecosystem Markets	Effective Outreach Booths	Accessing Watershed and Community Information from the Oregon Explorer	Processing Payroll Efficiently - A Panel Discussion	Odell Creek Dam Removal & Hydroelectric Decommissioning
8:30 AM - 9:30 AM	Forestry 101: Skills, Strategies & Resources to Assist Family Forest Landowners	Overview of the Pesticide Analytical and Response Center	Where Energy Meets Restoration: The Klamath Energy and Water Savings Program	Assisting Landowners that Do Not Have Cash Flow for Projects	ODA's Ag Water Quality Management Program's Strategic Initiatives and the Clean Water Partnership
9:45 AM - 10:45 AM		How Invasive Species Affect the Work of SWCDs: An Opportunity for Collaboration in the Fight against Invasive Species	Rules and Regulations When Working with Drones		Facilitation Skills for Leaders
11:00 AM - 12:00 PM					Surviving in a One Person Office
12:00 PM					Director Training for Those Left Out in the Winter Weather
					Monitoring that Guarantees Measurable Results

# ap anderson perry & associates, inc.

engineering · surveying · natural resources

*Engineering for:*

- |                          |                         |
|--------------------------|-------------------------|
| River/Stream Restoration | Permitting Assistance   |
| Fish Passage             | Archaeological Services |
| Water Resources          | GIS Services            |
| Drinking Water           | Stormwater              |
| Wastewater               | Site Development        |
| Roads                    | Irrigation              |
| Bridges                  | Survey                  |

La Grande, Oregon  
(541) 963-8309

Walla Walla, Washington  
(509) 529-9260

Prineville, Oregon  
(541) 362-8682

[www.andersonperry.com](http://www.andersonperry.com)



## NORTHWEST WATERSHED RESTORATION

Northwest Watershed Restoration, LLC embraces the vision of reestablishing watersheds in Oregon, Washington and Alaska. With a 25 year history, we proudly specialize in fish habitat and wetland enhancement, as well as river and stream bank restoration. Our dedicated team members are the leading professionals in channel excavation, woody habitat construction, native plant revegetation, slope and bank stabilization, and stream diversion. The experience and ever-expanding knowledge of our workforce enables us to produce creative solutions to the most challenging restoration projects. With over 250 restoration projects completed to date, we are excited to partner with the people that care for our land and resources.

[www.northwestwatershedrestoration.com](http://www.northwestwatershedrestoration.com)

5005 Eastview Lane NE, Silverton, OR 97381

Phone: (907) 252-2494

[tom@northwestwatershedrestoration.com](mailto:tom@northwestwatershedrestoration.com)



### the OREGON CONSERVATION STRATEGY

[OregonConservationStrategy.org](http://OregonConservationStrategy.org)

**A Blueprint for Conservation  
in Oregon**

Use ODFW Compass to view Strategy data layers  
and create custom maps and reports:  
[dfw.state.or.us/maps/compass](http://dfw.state.or.us/maps/compass)



@ODFWConserve



ODFWConservation



## SD | I | S Special Districts Insurance Services

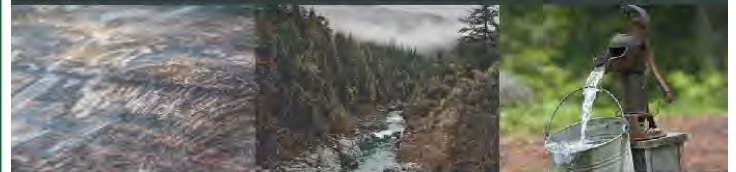

### Special Districts Insurance Services

*Over 30 years of experience in providing specialized and affordable insurance services for Oregon's domestic water, sanitary, and irrigation districts.*

SDIS has a broad offering of insurance coverages including liability, property, boiler & machinery, crime, workers' compensation, and more. Members of the program also enjoy many benefits including, but not limited to:

- Training, loss control, safety consultations, risk management and claims management services
- Research and technical assistance
- Pre-loss legal services for members enrolled in the property/casualty program
- Background check and drug-free workplace program
- Member ownership of a program where surplus revenues are invested to stabilize rates and enhance service

*Contact us today to learn why the majority of Oregon's special districts choose SDIS for their coverage needs.*

Administered by Special Districts Association of Oregon  
PO Box 12613 Salem, OR 97309  
Toll-Free: 800-285-5461 | Phone: 503-371-8667

SD | I | S Special Districts  
Insurance Services

SDA | O Special Districts  
Association of Oregon

9:45AM

**Organic Livestock and Conservation**

-10:45AM

**Ben Howell, Oregon Tilth & USDA NRCS**

Join this presentation to learn about opportunities for conservation when working with organic livestock producers. The workshop will cover organic regulations such as access to pasture and new requirements for outdoor access.

**Oregon's Land Use Program and Farmland Protection****Jim Johnson, ODA**

Protection of agricultural land is a hallmark of Oregon's Land Use Planning Program, protecting vast areas of farmland that support the State's second largest economic sector. Exclusive Farm Use zoning, Urban Growth Boundaries, Right to Farm... learn about these tools and others that provide this protection.

**Preparing a Competitive RCPP Proposal****Heather Medina Saucedo-NRCS Basin Team Leader, Bari Williams-NRCS Easement Program Specialist, Amie Loop-Frison-Yamhill SWCD, Herb Winters-Wheeler SWCD, Josh Thompson-Wasco SWCD**

NRCS's Regional Conservation Partnership Program (RCPP) offers opportunities for SWCDs and other partners to collaborate for conservation on a regional scale. Oregon is currently benefitting from 13 RCPP grants at over \$40 million total before match. These projects range from oak woodland habitat restoration in the Klamath Basin and North Willamette Valley, to irrigation efficiency and stream flow improvements in Wasco and Wallowa Counties and the lower John Day Basin and Tualatin Basins.

This presentation will start by highlighting elements of a competitive RCPP proposal and how to prepare for an ACEP-ALE component of a proposal. Then a panel of Oregon SWCDs that received RCPP grants will describe how they developed their concepts, coordinated diverse partners, found match funding, and created structures for long-term project management.

**Public Contracting in Oregon (9:45-Noon)****Eileen G. Eakins, Law Office of Eileen Eakins, LLC**

Oregon's public contracting requirements are complex and can seem intimidating. This session is designed to provide a basic framework for understanding what the law means by "public contract"; what requirements apply to different types of contracts; and how to make the contracting process as simple and streamlined as possible for your organization.

**Navigating Wetland and Waterway Regulation and Maintenance Across Oregon: An Overview (9:45-Noon)****Cory Owens-NRCS State Soil Scientist, Jericho Winter-NRCS Resource Soil Scientist, Mike Powers-ODA Ag Water Quality Program, Jaimee Davis-US Army Corps of Engineers Portland Permits Section Chief, Peter Olmstead-US Army Corps of Engineers Project Manager/Biologist, Russ Klassen-Department of State Lands Removal Fill Policy Specialist**

This session will provide participants with an overview of the various wetland regulations and guidance for waterway maintenance as they overlap and diverge between the four key wetland and waterway agencies in Oregon. A representative of each agency will present an overview of their wetland or waterway regulations or guidance followed by ample time for questions and discussion.

### **How to Communicate Effectively to Diverse Audiences Working in Agriculture and Natural Resources**

**Luisa Santamaria, OSU Extension NWREC**

Educators in agriculture and natural resources areas have to use all their skills to face some challenges communicating technical concepts or science-based information. Among these challenges are language, different levels of literacy and age. In order to develop a valuable educational material it is important to consider all these elements and think how it will benefit the audience we want to serve.

In this presentation attendees will identify some elements to consider when preparing presentations, reference material or hands-on activities for agricultural workers. The speaker will present some examples of educational material developed for target audiences.

11:00AM  
-NOON

### **Organic Farming and Water Quality**

**Ben Bowell, Oregon Tilth & USDA NRCS**

Join this workshop to discuss the impacts of organic farming on water quality. The presentation will focus on practices and opportunities to protect water quality, what the organic regulations require related to water quality, and latest research on the topic.

### **CREP Effectiveness Monitoring Study Update**

**Ken Fetcho, OWEB**

OWEB will present on the findings of its statewide Conservation Reserve Enhancement Program (CREP) Effectiveness Monitoring Study. Information will be provided on the study approach, the results and recommendations that were generated in coordination with a stakeholder Advisory Group.

### **The Confluence of Collaboration and Clean Water: How You Can Accomplish More through Partnerships**

**Lucas Nipp, East Multnomah SWCD**

Collaborative partnerships provide a framework to share data, discuss social and environmental needs, and ultimately facilitate a strategic prioritization of restoration activities. This presentation will describe the Beaver Creek Conservation Partnership, a collaboration of government agencies, a community college, non-profits, and landowners. It will describe how the partnership came together to share information and led to comprehensive monitoring and restoration within the watershed. It will also describe how the partners' efforts coalesced into a large-scale green infrastructure retrofit of the Mt. Hood Community College campus that lies at the confluence of Beaver and Kelly Creeks. The creeks are the lowermost tributaries in the Sandy River Basin, a regionally important salmon stronghold. This partnership can serve as a model for collaboration and demonstrate how shared goals can align to support watershed restoration and education.

### **How to Organize and Run an Effective Tax Levy Campaign**

**Colin Cochran, Hilltop Public Solutions**

The search for funding is a primary and, often, a stressful necessity for SWCDs. In an environment where funding streams are often unpredictable and inadequate to meet programmatic goals, securing or growing a stable and permanent funding base via property tax levy is an attractive option for SWCDs.

Campaign experts will present the steps necessary to prepare and execute a successful levy campaign and take questions from attendees about how they can begin planning for a levy campaign. Learn how to can build a steering committee, educate the greater public about the work of the District, and identify potential sources of funding. Examples will be drawn from the successful 2016 Tualatin Soil and Water Conservation District in November 2016.

**Noon**

### **Lunch**

**-1:30PM**

Join us in the banquet hall for lunch and some words from our partners.

**1:30PM**

### **Riparian Grazing Management with Water Quality Considerations**

**-2:30PM**

**Sandy Wyman, Rangeland Management Specialist, National Riparian Service Team**

Livestock grazing in relation to surface water streams, rivers, or ponds, has been a bone of contention for many years. Any perceived pollution potential by livestock is typically regulated with total removal of livestock from pastures or exclusion of water sources that increase management and maintenance costs for the livestock manager.

There is a host of grazing management strategies, tools, and techniques that may be used to decrease the potential for livestock related point or non-point source pollution. The task for livestock managers is to determine what mix of tools and techniques work with their livestock operation to maintain riparian and upland vegetation, and maximize use of pasture and rangeland forage that allows for plant growth and recovery.

### **Writing a Communication/Marketing Plan for Your Organization**

**Jane Hartline, West Multnomah SWCD**

Who does your organization need to reach out to? Who do you need to impress? What do they currently think about you? Or do they think about you at all? What are your messages to each group? What is it you want them to do? What are the best ways to reach each audience? In this session, we'll work together on a communications/marketing plan that you can take home to complete.

Jane Hartline left her 29-year career as marketing manager of the Oregon Zoo to retire and be more directly involved in conservation projects. Her many projects in the last few years have include communications plans for the Oregon Native Turtle Working Group and the 4-County weed management area. She is the director of the Sauvie Island Habitat Partnership and serves on the boards of both the West Multnomah SWCD and the Scappoose Bay Watershed Council. She is a seasoned weed warrior and runs a small native plant nursery on the side.

**Introducing OregonConservationStrategy.org and ODFW Compass 2.0****Arthur Rodriguez, Oregon Conservation Strategy GIS Analyst ODFW**

The Oregon Conservation Strategy is the overarching statewide strategy for conserving fish and wildlife in Oregon, providing a shared set of conservation priorities and presenting a menu of recommended voluntary conservation actions and tools. In 2016, ODFW unveiled OregonConservationStrategy.org; the 10-year update to the Strategy that incorporates new science and updates the Strategy format into an interactive, easily accessible website. At the same time, ODFW also released a major upgrade to the Compass mapping application; adding more datasets, tools to generate a Strategy report, and additional functionality to create and share customized maps. The Strategy and Compass websites were designed to easily direct users between both applications, providing spatial context for Strategy components within Compass. This presentation will include a brief overview of the 2016 Strategy revision, highlighting updates to Strategy Species, Key Conservation Issues, and Conservation Opportunity Areas, and demonstrations of the OregonConservationStrategy.org and ODFW Compass web applications.

**IGAs, MOUs, MOAs: The How, Why and When****Spencer Rockwell, Special District Association of Oregon**

Please join for a discussion of IGAs, MOUs, and MOA. Topics to be covered will include the differences between the agreements and when and how you can best use them to contract with other agencies/organizations.

**Updates from ODF: New Rules for Riparian Protection Standards & Bald Eagles****Ryan Gordon, Oregon Department of Forestry**

Join the Oregon Department of Forestry for an overview of proposed rule changes for increased riparian protection standards along small and medium salmon, steelhead, and bull trout streams in Western Oregon. We'll also discuss updates to protection standards for bald eagles. The presentation will summarize these new rules, explain the implementation timeline, highlight important points for small woodland owners, and identify helpful resources.

**Starting a Collaborative Effort in Your Community****Dr. Brenda Smith, High Desert Partnership & Dustin Johnson, OSU Extension Harney County**

In our work and experience with several initiatives in Harney County we believe engaging in a collaborative, solutions-oriented process with relevant stakeholders is perhaps the only viable and lasting means to addressing contemporary natural resource management and community issues that are often complex and highly contentious. True collaboration is a process that represents broad interests, is inclusive, has data to make decisions, and does not mean you have to give up the things you value to reach consensus. In this session we will discuss our experiences in a case study format and offer basic principles we believe are essential to facilitate establishment and maintenance of an effective collaborative.

**NRCS All DC Meeting (1:30-5:00)**

The annual all District Conservationists meeting brings together NRCS conservationists from around the state. This is a closed session for NRCS employees.



2:45PM

**Planning for Flood Emergencies: The Levee Perspective**

-3:45PM

**Angela Carkner, Multnomah County Drainage District**

This presentation will focus on the emergency planning for a levee system along the Columbia River in the Portland area. The Multnomah County Drainage District (MCDD) operates 27 miles of levee, 13 pump stations, and over 45 miles of ditches, sloughs, and streams which reduce the flood risk for significant regional assets across 12,000 acres of the Columbia Slough Watershed. In addition to a review of emergency flood response, we will review results from an assessment of the flood stage of the Columbia and Willamette Rivers on areas enveloped by our levees during extreme events in the future. The study, which was completed in 2016 through early 2017, was generated by The US Geological Survey and US Army Corps of Engineers. As the results are just coming out, I will discuss how MCDD and its other jurisdictional partners could use this information to improve our emergency response.

**Posts & Press Releases: Successful Writing for the Web****Tom Salzer, Clackamas SWCD**

Invest 60 minutes in learning how to write better posts and press releases for publishing to the web. Learn how to avoid clickbait! Learn about SEO! Increase value for your readers!

**AgBiz Climate Decision Support Tool: Help Producers Understand How Changes in the Climate Will Affect Their Bottom Line****Gabrielle Roesch-McNally, Northwest Climate Hub & Clark Seavert, Oregon State University**

Growers hear that temperatures will rise with climate change, but are never provided with specific information regarding what these changes will look like for their precise location. Projections of local changes in weather variables are needed in order to determine how their crops or livestock enterprises will be affected. This is why researchers at OSU have been developing *AgBizClimate*. It is a new decision tool that helps producers measure potential impacts of climate change on future net returns to crop and livestock enterprises. *AgBizClimate* has projections of 14 weather variables that may impact yields and product quality. Projections will eventually be available for each county in the US, with projections out to 2040. By developing crop and livestock budgets and viewing projections of weather variables that impact their yields or quality of products, producers can modify yield estimates and production inputs to approximate future net returns. Current and future net returns can then be compared to measure the impacts to their bottom-line. In addition, these future budgets can be used with *AgBizProfit* to observe the profitability of adaptation strategies or with *AgBizLease* to determine if current leases should be modified as a result of changing inputs. A whole farm/ranch analysis can also be developed using *AgBizFinance* to measure changes to a business' liquidity, solvency and profitability.

Gabrielle Roesch-McNally, Northwest Climate Hub will provide an overview of work being done in the region to reduce weather and climate related risks while characterizing some of the big picture impacts we can expect in Oregon due more variable and extreme weather events.

Clark Seavert, OSU Economist, will demonstrate, via a hands on workshop, how *AgBizClimate* can help producers make critical and informed decisions regarding climate change adaptations on their crops and livestock enterprises. He will illustrate how to allocate data to develop enterprise budgets with *AgBiz Logic*, the basics behind the *AgBizClimate* program, and how to

develop scenarios for your clientele or research projects. As a result of this interactive session, you will have the knowledge to gather the appropriate information from university budgets, provided with the program, develop scenarios for your particular location, and interpret the output for your clientele. To fully understand the *AgBizClimate* program are encouraged to bring your laptop.

### **From Collaborative Planning to Project Implementation: How Oregon's Water Resources Development Program Partners With Oregonians to Meet Water Needs**

**Kim Ogren PhD, Oregon Water Resources Department**

The Water Resources Development Program helps individuals and communities address instream and out-of-stream water resource needs through three opportunities. Place-Based Planning empowers communities to work collaboratively, in partnership with the state, to understand their instream and out-of-stream resource needs and identify potential solutions to meet those needs. Feasibility Study Grants cover up to 50 percent of the costs of studies to evaluate the feasibility of developing water conservation, reuse, and storage projects. Water Project Grants and Loans allow the state to invest in projects that meet instream and out-of-stream needs, while providing economic, environmental, and social/cultural benefits. The presentation will include an overview of the three program components and describe opportunities to connect to these resources.

### **Cultural Resources Protection Regulations with OWEB (2:45-5:00)**

**Session Moderator: Ken Fetcho, Effectiveness Program Manager, OWEB;**

**Speakers: Chuck Sams, Interim Deputy Executive Director from the Confederated Tribes of the Umatilla Indian Reservation, Carey Miller-Confederate Tribes of the Umatilla Indian Reservation, John Pouley-State Historic Preservation Office, Amy Charette-Confederate Tribes of the Warm Springs Reservation of Oregon, Taylor Murray-Farm Service Agency**

Learn about cultural resources protection regulations, what to look for, when to look for assistance. How to obtain a permit, ensure compliance, meet permit conditions. Obtain perspectives from the State of Oregon, from the Confederated Tribes of the Umatilla Indian Reservation and Confederated Tribes of the Warm Springs Reservation of Oregon, and hear an update on how FSA and NRCS are working together to address cultural resources protection compliance for CREP. Leave the session with an awareness of available resources and training opportunities.

### **Recipe for Effective and Productive Meetings: Easy as Pea Soup (2:45-5:00)**

**Donna Chickering, Rogue River Watershed Council**

We all have to attend meetings - too many for most of us! And many of them are painfully nonproductive. If you're responsible for planning and/or facilitating meetings and are looking for guidance on how to hold meetings that people actually want (or at least not hate) to attend, this is the session for you. We'll be looking at the ingredients necessary for pain-free, productive meetings, and you'll get a chance to practice some associated skills enabling you to plan and direct better meetings immediately. (Please bring at least one example of an agenda of a recent meeting you've attended.)

4:00PM

**Saving Habitat for Streaked Horned Lark**

-5:00PM

**Dana Green, Port of Portland**

Streaked Horned Larks (*Eremophila alpestris strigata*) are a threatened bird species under the federal Endangered Species Act that occupy sparse, recently disturbed grasslands in Western Washington and Oregon. This presentation describes their unique habitat requirements and conflicts in land use associated with their presence on airport and industrial land. Learn about the Habitat Conservation Plan presented to the U.S. Fish and Wildlife Service to create and manage habitat at the proposed Sandy Island conservation area, which would be the first and only site that is managed solely for the conservation of Streaked Horned Larks.

**Recipe for Success: How to Hold a GREAT Event****Melissa Newman-Benton SWCD, Marc Bell-Polk SWCD, Heath Keirstead-Benton SWCD, Michelle Delepine-West Multnomah SWCD, Lisa Kilders-Clackamas SWCD**

This session will offer tips, lessons learned, and important considerations when planning and holding a fantastic event. Hear from your peers about tried and true strategies, pitfalls, and safety concerns whether your event is a field tour, workshop, or training.

**Administering Small Grants Round Table****Shilah Olson and Abbie Forrest-Wasco SWCD, Kathy Leopold-OWEB**

District, Councils, and Board members who are involved with a Small Grant Team will not want to miss this session. Program manager for the OWEB Small Grant Program, Kathy Leopold, will walk the group through the in's and outs of the application and review process, eligible and non-eligible projects, as well as new rules and changes to the program for the next biennium. There will be time for Q&A so, please bring your project ideas, and any lingering questions.

5:00PM

**Sponsor Meet & Greet**

-6:00PM

Socialize with colleagues and visit every sponsor table!

**Oregon Soil Health Partners**

Join folks from around the state interested in promoting soil health partnerships. Co-hosted Cory Owens, NRCS and Teresa Matteson, Benton SWCD to learn about the group and our events, discuss ways to get involved, and share ideas for increased collaboration.

6:00PM

**Banquet**

Enjoy Dinner in the Banquet Hall while connecting with fellow conservation enthusiasts and hearing from our partners.

7:00AM

**Breakfast**

-8:30AM

Join us in the banquet hall for breakfast.

8:00AM

**Registration Desk Open**

-5:00PM

The registration desk will be open to help with check-in, check-out, returning conference evaluations and name tags, and answer your question.

8:30AM

**Unlocking Carbon Markets for Family Forest Owners: Innovation for**

-9:30AM

**Overcoming Transaction Costs in Ecosystem Markets**

**Brian Kittler, Pinchot Institute**

Markets for carbon offsets are global and offset types transacted in these markets include projects that restore or improve the ability of forests and other ecosystems to sequester and store carbon. To date, non-industrial family forests have not been able to access carbon markets in a meaningful way. A new program in Western Oregon and Washington is blending USDA NRCS conservation programs and innovative carbon measurement technology, with a partnership approach to delivering technical and financial assistance to landowners. This session will describe this program and its early results.

**Effective Outreach Booths**

**Tracy Robillard, NRCS Public Affairs Officer.**

Setting up a booth at public events is a common tool in the toolbox for conducting program outreach, but how do you make the most effective use of a booth? How do you draw people in? How will they remember your message? In this session, participants will discuss tips for planning and coordinating an effective outreach booth. Feel free to share your own lessons learned from outreach booths.

**Accessing Watershed and Community Information from the Oregon Explorer**

**Janine Salwasser, Oregon Explorer Program Lead, Institute for Natural Resources**

Learn how to access data and information resources for all the basins, watersheds, and communities in Oregon using the redesigned Oregon Explorer site ([www.oregonexplorer.info](http://www.oregonexplorer.info)). Several new tools will be demonstrated, such as making a map or generating a community report for any place in Oregon using the Planner's Map Viewer, creating charts and tables for more than 540 indicators with the Communities Reporter Tool, or using the Oregon Atlas for simple place-based mapping and charting of floodplains, demographics, habitat, land use, and more.

**Processing Payroll Efficiently – A Panel Discussion**

**Tara MacMillan-Upper Deschutes Watershed Council, Jason Faucera-Clackamas SWCD, and Debbe Chadwick-Jefferson SWCD**

A panel of fiscal agents will discuss what they use to track employee time and process payroll. Upper Deschutes Watershed Council uses the QuickBooks Timer function in processing payroll and will discuss employee time tracking using the QuickBooks Timer, payroll and Payroll Allocation Process. Clackamas SWCD has a contractor that processes payroll based on entry of employee time data into their online payroll portal. In order to facilitate that process, CSWCD uses MS Excel timesheets to ensure time reporting follows District personnel policy, and to prevent errors. We'll share how we employ Excel method to make time reporting more secure,

efficient, and accurate. Jefferson SWCD will discuss how they use Payroll and Time Sheets in QuickBooks leading to easy and detailed report generation for various grant funds.

### **Odell Creek Dam Removal & Hydroelectric Decommissioning**

**Cindy Thieman, Hood River Watershed Group**

During the 1980's many small, private hydroelectric projects were built across Oregon in response to high power prices and concerns about security of energy supply. Such a project was built in 1983 on Odell Creek, a tributary to the Hood River. The 12-foot tall dam included a fish ladder and screen, penstock, and power house. The project had a 25-year permit from Oregon Water Resources Department to divert water for power generation. When the permit expired in 2010, both the energy market and regulatory requirements had changed. The fish ladder and screen did not meet current ODFW standards, and energy prices did not support an expensive upgrade to meet the new standards. At this point, the dam operator approached the watershed council to explore opportunities for a fish ladder upgrade or dam removal. Ultimately dam removal and stream restoration was selected as the path forward. This talk will focus on lessons learned, including the complexities of landowner relationships, the dam's FERC exempt status, permitting, and ultimate implementation of a half-million dollar restoration project.

### **Surviving in a One Person Office**

**Shawn Morford, NOWC and Karen Moon, Harney County Watershed Council**

The goal of this session is to provide an opportunity for Council staff to talk about the challenges of working in a one person office. Sharing ideas on how to prioritize multiple projects, office logistics, time management, board/council management and where to go to find help will be some of the topics.

### **Director Training for Those Left Out in the Winter Weather (8:30-Noon)**

**Eric Nusbaum, ODA**

Did the Director Training near you get cancelled due to the weather? Or did no day really work for you? Well, here is your chance to get the training you wanted. The training will include an update on what's happening at ODA as well as training on District as Advocate, Modern Communication, Crisis Management, and a mystery session called "The Top Ten".

9:45AM

### **Forestry 101: Skills, Strategies & Resources to Assist Family Forest Landowners**

-10:45AM

**(9:45-Noon)**

**Ryan Gordon-ODF, Misty Seiboldt-NRCS, Michael Ahr-West Multnomah SWCD, Stephen Fitzgerald-OSU Extension, and Friends**

Do you struggle to see the forest for the trees? Forest landowners play an important role in the work you do, yet they may not be your traditional customer. Join us for an extended session that will focus on (1) a basic introduction to the field of forestry, (2) strategies for applying the skills you already possess to help forest landowners, (3) an overview of the resources readily available to forest landowners, and (4) a high level review of some key regulatory considerations for forest operators. We can't transform you into a forester over two hours, but we can provide tools and strategies to field forestry questions and help forest landowners access technical and financial assistance.

### **Overview of the Pesticide Analytical and Response Center**

**Ted Bunch, ODA**

Session attendees will be presented with an overview of pesticide regulation and pesticide toxicology. This session will also provide the audience with an overview of the Pesticide Analytical and Response Center (PARC). PARC was created by executive order in 1978 and is mandated to perform the following activities with regard to pesticide-related incidents in Oregon that have suspected health or environmental effects: Collect incident information, mobilize expertise for investigations, identify trends and patterns of problems, make policy or other recommendations for action, report results of investigations, and prepare activity reports for each legislative session. Select examples of pesticide-related incidents will also be discussed.

### **Where Energy Meets Restoration: The Klamath Energy and Water Savings Program**

**Bill Lehman, Klamath Watershed Partnership and Bridgett Callahan, Sustainable Northwest**

In the summer of 2015, Sustainable Northwest, Energy Trust of Oregon, and Wy'East RC&D formed a collaboration with the Klamath Watershed Partnership to help Klamath county agricultural producers lower energy costs through on farm energy conservation and energy efficiency improvements. The program (Klamath Energy & Water Savings) was specifically designed to address water saving measures through energy conservation for irrigators. On-the-ground assessments, education and outreach, and technical assistance provided agricultural producers the support they needed to improve on farm efficiency – saving energy and water. Cost share programs through local utility, and federal and state programs were utilized to reduce energy expenses and help save water. This ongoing program works in coordination with the watershed's existing restoration programs and projects while improving and expanding the dialogue the watershed council has with agricultural producers. This collaborative approach through the Klamath Watershed Partnership can be replicated to help other watershed councils work with agricultural producers to achieve energy and water saving while increasing restoration opportunities.

### **Assisting Landowners that Do Not Have Cash Flow for Projects**

**Panelists: Bryan Vogt, District Manager, Monument SWCD; Christo Morris, Executive Director, Powder Basin Watershed Council; Eann Rains, Conservation Investments Coordinator, Clackamas SWCD; Herb Winters, Conservation Specialist, Wheeler SWCD; Karin Stutzman, District Manager, Polk SWCD**

For various reasons, cash flow can be a problem when implementing projects. Some landowners are unable to do the work themselves. Some can contribute labor or materials but not cash. Others could contribute cash but can't pay the bills upfront and wait for reimbursement. When resource availability is a problem, what methods do Districts and Councils use to get the project done? What are the benefits of those approaches? What are the risks to the landowner, the District, or the Council?

Approaches we will discuss include grants (federal, state, local, tribal, foundation, SWCD); Clackamas SWCD's loan program; USDA programs; Farm Aid; in-kind contributions; webinars on low-cost methods for installing conservation practices; and fundraising ideas. Everyone in the room is invited to participate in the conversation and share ideas and experiences.

## ODA's Ag Water Quality Management Program's Strategic Initiatives and the Clean Water Partnership

Sheila Marcoe, ODA

This session will provide the audience with an update on ODA's Strategic Initiatives - Strategic Implementation and Focus Areas. Topics include: work that has been completed by ODA and partners, work currently underway, and future opportunities. Plus a discussion about how these initiatives fit within the Governor's Natural Resources Office and the Clean Water Partnership.

## Facilitation Skills for Leaders

Robin Harkless, Oregon Consensus

Come join this session to learn about working with disruptions/disruptive or challenging participants, how to wear multiple hats, and gain tips for overcoming stumbling blocks in a process.

## Monitoring That Guarantees Measurable Results

Organized by NOWC

This session is open to watershed council, district, and land trust staff registered for the 6-part Monitoring Study Design webinar course taught by the River Network and organized by the Oregon Conservation Partnership. It will serve as the introductory session to orient participants to the webinar series and introduce the "whys" and "hows" of monitoring design and data quality, utility and management. Priority will be given to those already registered for the series, but open to others as there is room (to register for the course, go to: <https://www.surveymonkey.com/r/PY3S7DG>).

11:00AM  
-NOON

## How Invasive Species Affect the Work of SWCDs: An Opportunity for Collaboration in the Fight against Invasive Species

Dr. Helmuth Rogg, ODA State Plant Regulatory Official

The Insect Pest Prevention & Management Program (IPPM) and the Noxious Invasive Weeds Program of the Oregon Department of Agriculture are tasked to early detect and rapidly respond to invasive species invasions. The approach is to systematically survey for invasive pests and weeds throughout Oregon, quickly delimit any incipient invasive species population, and attempt to eradicate it before it can permanently establish. If an invasive species managed to become wide-spread or established, our programs consider control management options that focus on biological control. In many instances, our programs coordinate survey and control activities with our local SWCD partners, in particular in the management of noxious weeds. We will present a few examples where our programs would like to strengthen our collaborative efforts with the SWCDs, including Gypsy Moth, Japanese beetles, and aquatic noxious weeds.

## Rules and Regulations When Working with Drones

Steve Lawn, FAA licensed remote pilot

Steve Lawn, an FAA licensed remote pilot will give a presentation on the newest FAA rules and regulations regarding operations of Small Unmanned Aerial Systems in the National Airspace. The presentation will focus on recent Part 107 rules that have made it easier for people desiring to fly UAS to get in the air.







# Heartfelt Thanks to Our Speakers!

To the professionals who share their time and expertise to make CONNECT 2017 an extraordinary conference.

Eric Nusbaum, ODA  
Richard Gardner, CTUIR Silviculture Forester  
Dr. Stephen Machado, Columbia Basin Ag Research Center  
Cory Owens, NRCS State Soil Scientist  
Marcelo Bonta, Philanthropy Northwest Momentum Fellowship, Healthy Environment Program  
Shannon Andrews, Oregon State University - Central Analytical Lab  
Mace Vaughan, Xerces Society  
Michael Crabtree, Yamhill SWCD  
Eileen G. Eakins, Law Office of Eileen Eakins, LLC  
Gene Foster, DEQ  
Marko Bey, Lomakatsi Restoration Project  
Belinda Brown, Lomakatsi Restoration Project  
Carl Wilmsen, Northwest Forest Worker Center  
Corrina Chase, Columbia Slough Watershed Council  
Jim Cathcart, West Multnomah SWCD  
Jennifer Moore Kucera, NRCS - Soil Health Division  
Jean-Paul Zagarola, Bonneville Environmental Foundation  
Julie Harvey, Department of Environmental Quality  
Chelsea White-Brainard, East Multnomah SWCD  
Aaron Guffey, East Multnomah SWCD  
Chris Schachtschneider, OSU Extension Services  
Cassie Cohen, Portland Harbor Community Coalition  
Art McConville, Portland Harbor Community Coalition  
Maddee Rubenson, Oregon DEQ  
Tonya Dombrowski, Oregon  
Koto Kishida, Oregon DEQ  
Eric Quaempts, Confederate Tribes of Umatilla Indian Reservation  
Mike Running, Coalition of Oregon Land Trusts  
Ben Bowell, Oregon Tilth & USDA NRCS  
Jim Johnson, ODA  
Heather Medina Saucedo, NRCS  
Bari Williams, NRCS  
Amie Loop-Frison, Yamhill SWCD  
Herb Winters, Wheeler SWCD  
Josh Thompson, Wasco SWCD  
Jericho Winter, NRCS  
Mike Powers, ODA Ag Water Quality Program  
Jaimee Davis, US Army Corps of Engineers  
Peter Olmstead, US Army Corps of Engineers  
Russ Klassen, Department of State Lands  
Luisa Santamaria, OSU Extension NWREC  
Ken Fetcho, OWEB  
Lucas Nipp, East Multnomah SWCD  
Colin Cochran, Hilltop Public Solutions  
Jane Hartline, West Multnomah SWCD  
Sandy Wyman, National Riparian Service Team  
Arthur Rodriguez, ODFW  
Spencer Rockwell, Special District Association of Oregon  
Ryan Gordon, Oregon Department of Forestry  
Dr. Brenda Smith, High Desert Partnership  
Dustin Johnson, OSU Extension Harney County  
Angela Carkner, Multnomah County Drainage District  
Tom Salzer, Clackamas SWCD  
Gabrielle Roesch-McNally, Northwest Climate Hub  
Clark Seavert, Oregon State University  
Kim Ogren PhD, Oregon Water Resources Department  
Chuck Sams, Confederated Tribes of the Umatilla Indian Reservation  
Carey Miller, Confederate Tribes of the Umatilla Indian Reservation  
John Pouley, State Historic Preservation Office  
Amy Charette, Confederate Tribes of the Warm Springs Reservation of Oregon  
Taylor Murray, Farm Service Agency  
Donna Chickering, Rogue River Watershed Council  
Dana Green, Port of Portland  
Melissa Newman, Benton SWCD  
Marc Bell, Polk SWCD  
Heath Keirstead, Benton SWCD  
Michelle Delepine, West Multnomah SWCD  
Lisa Kilders, Clackamas SWCD  
Shilah Olson, Wasco SWCD  
Abbie Forrest, Wasco SWCD  
Kathy Leopold, OWEB  
Brian Kittler, Pinchot Institute  
Tracy Robillard, NRCS Public Affairs Officer  
Janine Salwasser, Institute for Natural Resources  
Tara MacMillan, Upper Deschutes Watershed Council  
Jason Faucera, Clackamas SWCD  
Debbe Chadwick, Jefferson SWCD  
Cindy Thieman, Hood River Watershed Group  
Shawn Morford, NOWC  
Karen Moon, Harney County Watershed Council  
Misty Seiboldt, NRCS  
Michael Ahr, West Multnomah SWCD  
Stephen Fitzgerald, OSU Extension  
Ted Bunch, ODA  
Bill Lehman, Klamath Watershed Partnership  
Bridgett Callahan, Sustainable Northwest  
Bryan Vogt, Monument SWCD  
Christo Morris, Powder Basin Watershed Council  
Eann Rains, Clackamas SWCD  
Karin Stutzman, Polk SWCD  
Sheila Marcoe, ODA  
Robin Harkless, Oregon Consensus  
Dr. Helmuth Rogg, ODA State Plant Regulatory Official  
Steve Lawn, FAA licensed remote pilot

# Get to know our SPONSORS

## Ambassador Sponsors



United States  
Department of  
Agriculture

Natural Resources Conservation Service



Oregon  
Conservation  
Partnership



## Wetland Sponsors



## Tributary Sponsors

Oregon Department of Fish & Wildlife

Special Districts Association of Oregon

Northwest Watershed Restoration, LLC

## Friends of OCEAN Sponsors

Oregon Department of Forestry

Idaho Power Company

Soil Water Conservation Society



# Oregon Conservation Partnership



NETWORK of OREGON  
WATERSHED COUNCILS



Oregon Association of  
Conservation Districts

