



CONNECT 2019

Presented by OCEAN and the Network of Oregon Watershed Councils



11th Annual
April 9-11, 2019
Sunriver, OR

Sunriver Resort Maps

Welcome to CONNECT 2019 at Sunriver Resort.

A few locations to note...

- All meals will be in the Great Hall.
- Education & Outreach, Manager/Admin, and Wildfire tracks will be located in the Great Hall building.
- Technology, Vegetation, and Water tracks will be held in the Homestead building.
- The Registration Desk will be located in the Homestead Gallery.
- NRCS's all DC meeting will be held in the Sunriver Lodge where you checked into your hotel rooms.

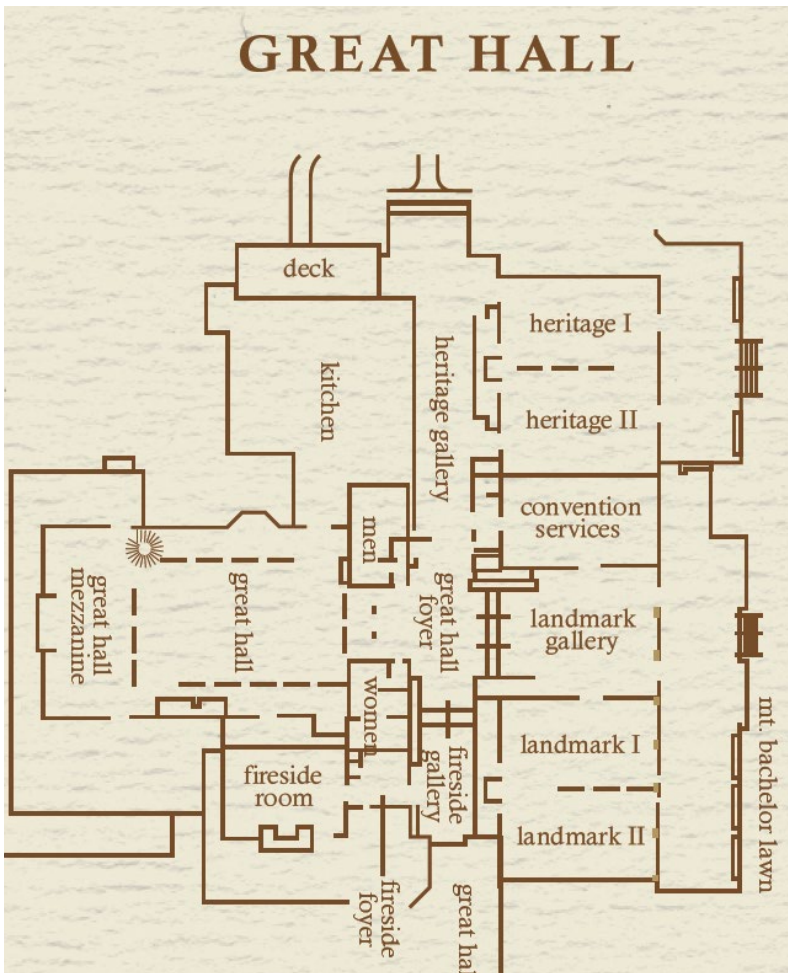
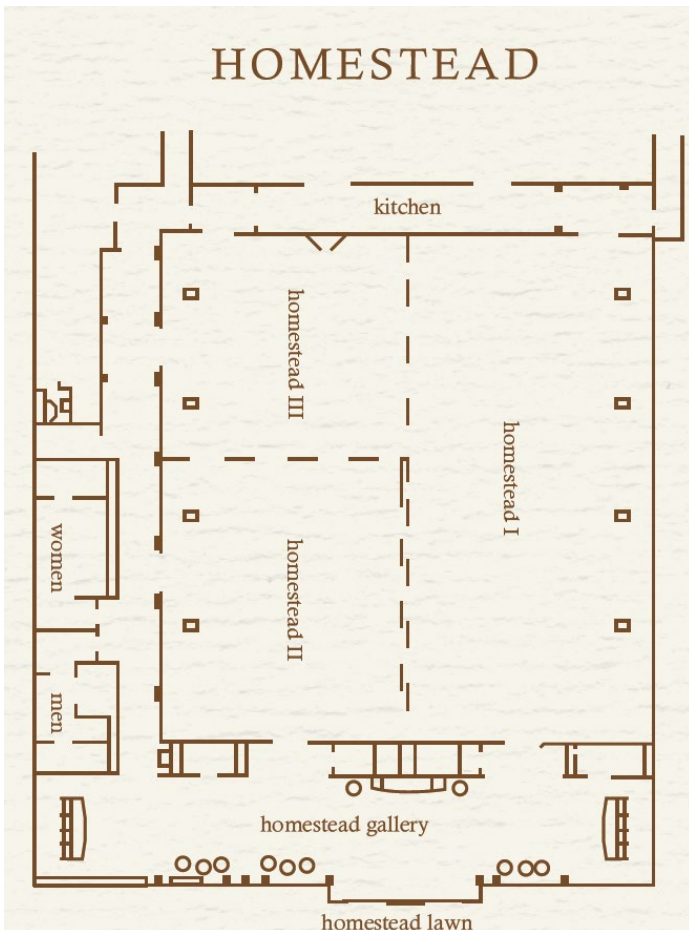

Table of Contents

Resort Map	2
Table of Contents & Welcome	3
OCEAN, NOWC, COLT and OACD Boards	4
SWCD, Watershed Council, and Land Trust Maps.....	5-7
Planning Team Members.....	8
Daily Schedules	
Monday.....	8
Tuesday.....	9
Wednesday.....	15
Thursday.....	30
CONNECT Agenda.....	18-19
Speakers	34-35
Get to Know Our Sponsors	17,20,35,36

Welcome to CONNECT



OREGON CONSERVATION
Education & Assistance Network

Hello and welcome to CONNECT 2019 at Sunriver Resort!

We are happy to be back in the center of our great state for the 11th installment of the CONNECT Conference. This year's conference has produced 6 tracks and 58 individual breakout sessions. Of note for this year is a track focused entirely on Wildfire, a series of sessions on Climate and a ½ day program devoted specifically to White Oak and prairie restoration.

We are thrilled to have over 290 registered attendees with the bulk being from Soil and Water Conservation Districts and Watershed Councils, as well as a variety of participants from our colleagues in conservation including the Oregon Department of Environmental Quality, United States Fish & Wildlife Service, Oregon Department of Agriculture, Oregon Department of Forestry, and the Natural Resources Conservation Service.

As always, the CONNECT Conference planning team has done a wonderful job in creating this diverse content and we thank you for your dedication and hard work. We would also like to acknowledge the vital financial support and technical resources provided by NRCS, OWEB, and ODA to help bring this conference to fruition.

We are fortunate to be able to come together again to learn, listen, share and CONNECT with other professionals who are devoted to community and voluntary conservation of our natural resources. Welcome to Sunriver and CONNECT 2019! Please don't break anything while you're here.

Jeremy Baker,
OCEAN President

Meet The Boards of The Oregon Conservation Partnership Members

OCEAN Board

President-Portland/Salem Metro: Jeremy Baker, East Multnomah SWCD

Vice President-Eastern At-large: Shilah Olson, Wasco SWCD

Treasurer-Eastern At-large: Janet Greenup, Morrow SWCD

Secretary-Northwest Oregon: Kari Hollander, Columbia SWCD

Eastern Oregon: Kyle Waggoner, Umatilla County SWCD

Southern Oregon: Clint Nichols, Jackson SWCD

Western At-large: Jason Faucera, Clackamas SWCD

Columbia Plateau: Herb Winters, Gilliam County SWCD

Western At-large: Cathy McQueeney, Clackamas SWCD

Eastern At-large: Scott Susi, Sherman County SWCD

Western At-large: Vacant

NOWC Board

Kelly Timchak, President
Coordinator, Lower Rogue Watershed Council

Cindy Thieman, Vice President
Coordinator, Hood River Watershed Group

Kristen Larson, Secretary
Executive Director, Luckiamute Watershed Council

Jon Souder, Treasurer and at-large member
Assistant professor, OSU Extension Service

John Speece-Middle Deschutes Watershed Council

Eric Riley-Partnership for the Umpqua Rivers

Amy Stiner-South Fork John Day Watershed Council

Debra Bunch-Mid John Day/Bridge Creek Watershed Council

Karen Moon-Harney County Watershed Council

Bill Lehman-Klamath Watershed Partnership

Guy Sievert-Nestucca-Neskowin-Sand Lake Watershed Council

Cindy Kolomechuk, at-large member
Member, Sandy River Basin Watershed Council

Rich Margarem, at-large member, University of Oregon

COLT Board

Lance Colburn – Blue Mountains Conservancy

Tim Copeland – Blue Mountain Land Trust

Glenn Lamb – Columbia Land Trust

Brad Chalfant – Deschutes Land Trust

Kevin Gorman – Friends of the Columbia Gorge Land Trust

Jessica McDonald – Greenbelt Land Trust

Crystal McMahon – Klamath Lakes Land Trust

Kate Morrison – Lower Nehalem Community Trust

Joe Moll – McKenzie River Trust

Katie Voelke – North Coast Land Conservancy

Frank O’Leary – Oregon Rangeland Trust

Connie Best – Pacific Forest Trust

Cathy Dombi – Southern Oregon Land Conservancy

Evan Smith – The Conservation Fund

Derek Johnson – The Nature Conservancy

Esther Lev – The Wetlands Conservancy

Owen Wozniak – Trust for Public Land

Kathleen Ackley – Wallowa Land Trust

Ann Schmierer – Wild Rivers Land Trust

OACD Board

Pat Fitzgerald, President-Yamhill SWCD

Terri Preeg-Riggsby, First Vice President-West Multnomah SWCD

Brian Lightcap, 2nd Vice President-West Multnomah SWCD

Jan Lee, Secretary-Clackamas County SWCD

Ken Bailey, Treasurer-Wasco County SWCD

Mark Saelens, Immediate Past President-Lincoln SWCD

North Coast Basin: Randy Bergman – Columbia SWCD

Lower Willamette Basin: Brian Lightcap – West Multnomah SWCD

Upper Willamette Basin: Mark Saelens – Lincoln SWCD

Southwest Oregon Basin: Vacant

Deschutes/Hood River Basin: Ken Bailey – Wasco SWCD

High Desert Basin: Martin Kerns – Klamath SWCD

John Day/Umatilla Basin: Tom Straughan – Umatilla SWCD

Snake River Basin: Walt Jury – Keating SWCD

OCEAN President: Jeremy Baker – OCEAN

Oregon Watershed Councils

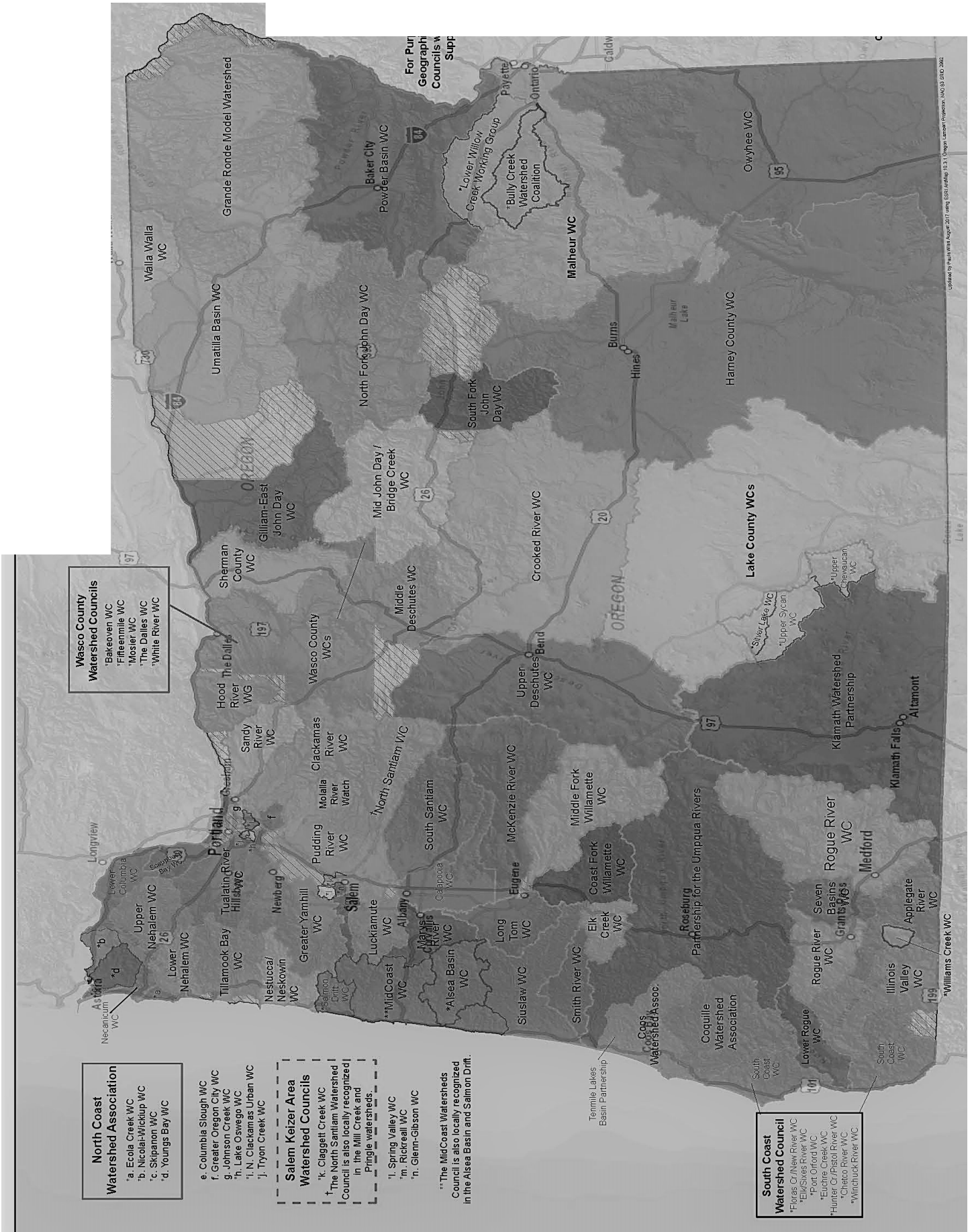

Wasco County Watershed Councils

- *Bakoven WC
- *Fifteenmile WC
- *Mosier WC
- *The Dalles WC
- *White River WC

North Coast Watershed Association

- *a. Ecole Creek WC
- *b. Nicola-Wickup WC
- *c. Skipanon WC
- *d. Youngs Bay WC

Salem Keizer Area Watershed Councils

- e. Columbia Slough WC
- f. Greater Oregon City WC
- g. Johnson Creek WC
- h. Lake Oswego WC
- i. N. Clackamas Urban WC
- j. Tryon Creek WC

South Coast Watershed Council

- *Flores C/New River WC
- *Elks/Sixes River WC
- *Port Orford WC
- *Eugene Creek WC
- *Hunter C/Pistol River WC
- *Chetco River WC
- *Winchuck River WC

Mid-Coast Watersheds

Council is also locally recognized in the Alesia Basin and Salmon Drift.

- *l. Spring Valley WC
- *m. Rickreall WC
- *n. Glenn-Gibson WC

Updated by Paul Wiers August 2017 using ESRI, Oracle 10.3.1, Oregon Lambert Projection, NAD 83, SRID 2622.



COLT MEMBERS WITH STATEWIDE SERVICE

OREGON RANGELAND TRUST	THE CONSERVATION FUND	THE TRUST FOR PUBLIC LAND
THE WETLANDS CONSERVANCY	THE NATURE CONSERVANCY	PACIFIC FOREST TRUST

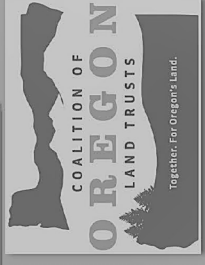

4-8-19

MONDAY, APRIL 8TH

**3:00 PM
-6:00 PM**

SWCC Meeting
Homestead 2 Room

3:00	Strategic Plan Work Session	Barbara Boyer
3:05	Strategic Plan Subcommittee Report	Eric Nusbaum
3:20	Discussions/Update of plan	All SWCC
6:00	Adjourn meeting	Barbara Boyer

**5:00 PM
-7:00PM**

Registration Open
Homestead Lobby

Thank you to Our CONNECT 2019 Planning Team!

Andrew Brown	East Multnomah SWCD
Anna Freitas.....	OACD
Anna Rankin.....	Pudding River Watershed Council
Cathy McQueeney	Clackamas SWCD
Charlotte Trowbridge.....	Tualatin SWCD
Clint Nichols.....	Jackson SWCD
Herb Winters.....	Gilliam SWCD
Jim Cathcart.....	West Multnomah SWCD
Jeremy Baker	East Multnomah SWCD
Judy Marsh	Tualatin SWCD
Juli Waarvik	Tualatin SWCD
Julie MacSwain.....	NRCS
Lisa Kilders.....	Clackamas SWCD
Maria Snodgrass	ODA
Matt Lee.....	Columbia Slough SWCD
Melaney Dunne.....	Coquille Watershed Association
Paul DeMaggio	Jackson SWCD
Sarah Mowry	Deschutes Land Trust
Shawn Morford.....	NOWC
Shilah Olson	Wasco County SWCD
Todd Peplin.....	Deschutes SWCD
Tom Salzer.....	Clackamas SWCD
Whitney Bailey.....	East Multnomah SWCD

7:00 AM
- 8:30 AM

Breakfast

Join us in the Great Hall for breakfast.

7:00 AM
- 5:00 PM

Registration Desk Open

The registration desk will be open to help with check-in, check-out, returning conference evaluations and name tags, and answer your questions.

8:00 AM
-11:30 AM

BIOCHAR: WHAT IS IT AND HOW CAN IT HELP RESTORE SOILS

Kristin Trippe, Kelpie Wilson, Claire Phillips

Learn how charred biomass (biochar) can increase soil productivity, reduce wildfire risk, and slow climate change. Biochar consultant Kelpie Wilson will present biochar basics and the science of biochar production. USDA ARS researchers (Kristin Trippe, Claire Phillips, Kylie Meyer) will present their Biochar Atlas decision support tool for biochar applications and discuss recent field trials using biochar in restoration. We will conclude with a demonstration of a small-scale biochar kiln showing how biochar can be made in the field from brush and slash for use on site in restoration projects.

WORKSHOP OUTCOMES

Students will:

1. Be introduced to the chemistry and biology of biochar at scales ranging from atoms to the biosphere
2. Learn how biochar sequesters carbon while improving soil health and plant productivity
3. Understand available technology options for biochar production at different scales
4. Become familiar with the production of biochar through a hands-on demonstration

8:45 AM
-11:30 AM

FIELD TRIP-HIGH DESERT MUSEUM

Carpool to the High Desert Museum. Fees may apply \$13.60/person.

<https://www.highdesertmuseum.org/>

8:00 AM
-11:30 AM

FIELD TRIP-FORESTRY RESTORATION

There will be 3 stops that are relatively close to Sunriver.

The 1st stop will be looking at order 1 affects covering a recent prescription burn, challenges with urban interface and wildlife.

The 2nd stop will look at order 2 affects looking at a site that was treated 2 years ago with another that was treated 10 years ago. The discussion will revolve around maintenance and management objectives.

The 3rd stop will be in a HOA where they are undertaking fire prevention measures. Discussion around thinning prescriptions, working with communities, and challenges facing HOA's and other communities in forest settings.

**8:00 AM
-11:30 AM**

FIELD TRIP-RESTORATION TOUR CAMP POLK MEADOW PRESERVE

Join the Deschutes Land Trust and executive director Brad Chalfant for a tour of a major creek restoration project at the Land Trust's Camp Polk Meadow Preserve. In 2012 the Land Trust, in partnership with the Upper Deschutes Watershed Council and Deschutes National Forest, completed a multi-year restoration of Whychus Creek and its surrounding meadow at Camp Polk Meadow Preserve. Seven years later, Whychus Creek is making itself at home and the once dry meadow is springing back to life. Walk the restored meadow and see the robust streamside vegetation that has taken root, the paths the creek has chosen to follow, and how the restoration project has improved habitat for fish and wildlife. Hike Rating: This is a moderate 2-mile hike off-trail and through grassy meadows. What to Bring: Snacks, water, sturdy hiking shoes. Dress for the weather.

**8:00 AM
-11:30 AM**

**OREGON SOIL & WATER CONSERVATION COMMISSION
REGULAR QUARTERLY MEETING**

8:30	Welcome and Introductions	Barbara Boyer
8:35	Approve November 2018 Meeting Minutes	SWCC Members
8:40	Ag Water Quality Program Update	John Byers/Stephanie Page
9:10	Advisor Reports	
	• OSU	Sam Angima
	• NRCS	Ron Alvarado
	• OWEB	Courtney Shaff
	• ODF	Ryan Gordon
	• OCEAN	Jeremy Baker
	• OACD	Pat Fitzgerald/Anna Freitas
	• NOWC	Shawn Morford
9:45	HB 2958 discussion	Barbara
9:55	Land Use Issues/Legislative update	Jim Johnson
10:15	Break	All
10:30	ODA/OWEB updates	Stephanie Page/ Meta Loftsgaarden
11:30	Public Comment	
11:40	SWCC Member Reports and Wrap-up	SWCC Members
11:58	Adjourn	All

**NOON
- 1:20 PM**

LUNCH & WELCOME

Join OCEAN and partners in the Great Hall for lunch at Noon followed by they kick off to CONNECT, announcements, and important information. Don't be late!

1:30 PM
- 2:30 PM

SPEED NETWORKING AND OUTREACH MIXER (1:30-3:45)

The Speed Networking and the Outreach Mixer will give the participants a chance to meet the other outreach people across the state. The goal is to build a network where we can share ideas, call for help, and coordinate and share resources. The speed networking will allow everyone to have a few minutes to talk about something exciting they are doing, ask how someone solved a shared problem, or just introduce themselves. Once we all have a chance to meet one another, we will possibly have a round table, break up into smaller groups with a shared interest, and then just visit with one another.

1:30 PM
- 2:30 PM

RECORDS RETENTION WITH PANEL DISCUSSION

Sandi Hiatt-ODA, Kevin Payne-Morrow SWCD, Pat Holliday-Grant SWCD, and Liesl Coleman-Curry County SWCD

Sandi Hiatt with ODA will provide an overview of records retention from a state agency perspective. Each of our representatives, Kevin Payne, with Morrow SWCD; Pat Holliday, with Grant SWCD, and Liesl Coleman, with Curry SWCD will give a brief description on their records retention process and/or policies, and how it works day to day from the SWCD perspective. There will be a panel discussion and time for questions and answers.

The session goal is to provide information on record retention, provide supportive feedback to participants with questions, and provide helpful hints and tools from lessons learned on the job. This session is for anyone including those new to Special Districts and the state of Oregon. For the seasoned employee it can be a refresher with helpful reminders and examples on how other districts organize their records and the systems they use for record retention.

1:30 PM
- 2:30 PM

CATCH THE BUG

Christine Buhl, ODF

Perhaps the best wildfire prevention strategy is to manage a healthy resilient forest. But, what exactly is a healthy resilient forest? Christine will discuss the interaction between insect damage, disease, tree mortality and wildfire risk, and will challenge the common perception that increased tree mortality results in increased wildfire risk or that wildfire occurrence necessarily sets the table for insect pests and disease. Christine's talk will review the management strategies that reduce insect damage and disease risk in general; but will also point out that the world is not over when you do get an insect or disease outbreak or a wildfire. It all about the dose of impact and managing insect damage and disease risk based on an understanding of the timing of the increased risk following wildfire. Christine will also discuss the many beneficial insects that inhabit Oregon's forests and how wildfire can actually favor habitat for these beneficial insects.

1:30 PM
- 2:30 PM

CONNECTIVITY MODELING FOR CONSERVATION: THE OREGON CONNECTIVITY ASSESSMENT AND MAPPING PROJECT

Rachel E. Wheat, ODFW

There is a pressing need to initiate development of connectivity maps for a broad array of Oregon's terrestrial wildlife species. Anthropogenic landscape change can restrict the ability of wildlife to move across the landscape by adding barriers, instigating behavioral changes, impacting critical stopover sites, and increasing habitat fragmentation. To date, efforts to map connected habitat in Oregon have been based on expert opinion and have been insufficient for making decisions related to maintaining species' ability to move across the landscape. The Oregon Connectivity Assessment and Mapping project aims to utilize current best practices in landscape-scale connectivity assessment and mapping to assess existing habitat connectivity for terrestrial wildlife across the state. The fine resolution connectivity maps produced by this effort will provide utility to a wide diversity of partners, aiding in statewide planning and prioritization for strategic conservation investment, protection measures, siting for land use changes and development, mitigating barriers to animal movement, targeted restoration efforts, and transportation improvements, among many other uses.

1:30 PM
- 2:30 PM

GET CONNECTED: LESSONS SHARED FROM THE PNW-GARLIC MUSTARD WORKING GROUP & CLACKAMAS SWCD

Michelle Delepine, West Multnomah and Lindsey Karr, Clackamas SWCD

Garlic mustard (*Alliaria petiolata*) is an ODA-listed class B noxious weed and threatens many types of ecosystems in Western Oregon, as well as riparian corridors in Eastern Oregon. A self organized collaboration called the Pacific Northwest Garlic Mustard Working Group has brought together invasive plant managers from across Oregon and, Washington to share observations, best management practices, survey methodologies and outreach strategies across the region. Presentation will look at landscape-level management principles, convey the latest integrated pest management solutions for garlic mustard, and highlight methods for starting a working group to tackle natural resource goals across broad geographies. Presenters will also share how one SWCD in the working group is using a watershed approach to tackle the plant, using data on dispersal trends to inform outreach, surveys, and treatment strategies.

Visit the PNW-GMWG webpage: <https://tinyurl.com/PNW-GMWG-info>

Join the PNW-GMWG listserv: <https://tinyurl.com/PNW-GMWG-list>

1:30 PM
- 2:30 PM

COORDINATED STREAMSIDE MANAGEMENT PROGRAM: OWEB, ODA & PARTNERS

Courtney Shaff-OWEB, Ellen Hammond-ODA, Herb Winters-Gilliam SWCD, Drew Harper-Curry County SWCD, and Nick Haxton-Oregon DEQ

The Coordinated Streamside Management program is a collaborative effort between state, federal, and local partners to ensure riparian vegetation will provide for water quality protection. The program comprises three distinct, but overlapping, components: 1) voluntary, incentive-based conservation; 2) compliance with the state's Agricultural Water Quality Management Act's area rules; and 3) monitoring to track water quality improvements, and learn about and share the most effective conservation approaches. OWEB and ODA staff, along with local implementing partners, will discuss the variety of approaches to SIA implementation, focusing on voluntary conservation efforts and monitoring. Panel Participants ODA Staff OWEB Staff Two Grantees.

2:45 PM
- 3:45 PM

OUTREACH MIXER (1:30-3:45)

The Speed Networking and the Outreach Mixer will give the participants a chance to meet the other outreach people across the state. The goal is to build a network where we can share ideas, call for help, and coordinate and share resources. The speed networking will allow everyone to have a few minutes to talk about something exciting they are doing, ask how someone solved a shared problem, or just introduce themselves. Once we all have a chance to meet one another, we will possibly have a round table, break up into smaller groups with a shared interest, and then just visit with one another.

2:45 PM
- 3:45 PM

BE THE BOSS OF YOUR EMAIL: TAKE CONTROL OF YOUR INBOX

Bethanne Kronick, SIMPLIFY!

The average person can spend up to 40% of their eight hour work day sending and receiving up to 200 messages a day! It's no wonder that many of us always feel behind on projects and struggle to finish our work in a typical work day! Wouldn't you like to have some of that time back in your day? Everyone can benefit from learning to control and manage email to improve productivity!

This lively, interactive presentation provides strategies and solutions to boost productivity and efficiency with your email system and practices. You'll walk away with tips you can use right away.

Participants will:

- Learn how to minimize email overload
- Improve inbox management skills
- Develop more realistic response times
- Learn tips and tricks to utilize email more efficiently and effectively
- Learn productive email etiquette strategies

2:45 PM
- 3:45 PM

STORIES FROM CALIFORNIA'S CAMP FIRE

Pat McAbery, Gresham Fire & Emergency Services

Pat McAbery, a structural firefighter, will share his experience from being deployed to California's Camp Fire - the deadliest wildfire in the United States since the Cloquet fire in 1918. Named after Camp Creek Road in northern California's Butte County, its place of origin, the fire started on November 8, 2018. Pat will go over the fire's unprecedented spread on its first day - a run that destroyed the densely populated foothill town of Paradise - and the coordinated, firefighting response. The fire caused at least 86 civilian fatalities, injured 12 civilians and 5 firefighters, covered an area of 153,336 acres, and destroyed 18,804 structures, with most of the damage occurring within the first four hours.

2:45 PM
- 3:45 PM

UTILIZING DRONES IN RESTORATION

Herb Winters, Gilliam SWCD

This session will cover equipment options, available software applications, FAA compliance, and SDAO/OWEB requirements. Additional information on monitoring techniques, survey opportunities, and post-processing capabilities. We hope to give participants ideas on their future drone programs.

2:45 PM
- 3:45 PM

STRATEGIES AND CONSIDERATIONS FOR SUCCESSFUL RIPARIAN GRAZING

Pete Schreder, OSU Extension

Timing, intensity and frequency: What do those terms mean and how, exactly, do you manage them? We will discuss considerations for implementing a successful riparian grazing management strategy. The goal will be to examine the science behind creating a successful riparian grazing plan and review the ecologic and site-specific management objectives to consider when developing a riparian grazing strategy. This presentation will take us from the fundamental considerations to some site-specific examples as we talk through the process with real world examples. There is no one size fits all approach but with a basic understanding of the science and art of properly managed riparian grazing, successful grazing strategies can be a management tool for consideration.

2:45 PM
- 3:45 PM

OWEB'S CAPACITY INVESTMENTS: LEARNING FROM THE PAST AND PREPARING FOR THE FUTURE

Renee Davis and Courtney Shaff, OWEB and John Byers and Eric Nusbaum, ODA

OWEB, in coordination with ODA, has been providing watershed councils and soil and water conservation districts operating capacity funding for more than 20 years. By evaluating one of OWEB's longest running programs and developing lessons learned, we are demonstrating our commitment to meaningful monitoring and evaluation of our programs. At the conclusion of this process, OWEB and ODA can clearly tell the story of the value of capacity funds. We will also have new and innovative tools for tracking and reporting the outcomes and impacts of capacity investments. OWEB will provide an update on its approach to working with ODA to evaluate Operating Capacity funding in order to tell the story of the value of these investments in the capacity of watershed council and soil and water conservation districts. This session will help councils and districts better understand the framework that is being developed for this evaluation, how it connects with OWEB's strategic plan, and provide an opportunity to be engaged in the process.

4:00 PM
- 5:00 PM

OCEAN Annual Meeting

Join Oregon Conservation Education & Assistance Network for the 2019 Annual Meeting! Come hear updates, elect boardmembers, and see what the future holds for OCEAN.

5:00 PM
- 5:30 PM

Meet & Greet with Sponsors

Socialize with colleagues and visit every sponsor table!

5:00 PM
- 5:30 PM

Soil Health Meeting

Come join the soil health meeting.

5:30 PM
- 6:30 PM

Dinner

Enjoy Dinner in the banquet hall while connecting with fellow conservation enthusiasts and hearing from our partners.

6:15 PM
- 9:00 PM

OACD Annual Meeting

4-10-19

WEDNESDAY, APRIL 10TH

7:00AM

-8:30AM

Breakfast

Join us in the Great Hall for breakfast.

7:00AM

-8:30AM

Registration Desk Open

The registration desk will be open to help with check-in, check-out, returning conference evaluations and name tags, and answer your questions.

8:30 AM

- 9:30 AM

YOUR OUTREACH PLAN—TOOLS, TIPS AND TRICKS FOR ORCHESTRATING A SUCCESSFUL STRATEGY

Kathy Ferge, NRCS

Ensuring that your events and services are targeted to the appropriate audience, with an attention-grabbing message and adequate resources, is all part of a successful outreach plan. There are a number of resources available to ensure a stellar campaign. In this session we'll share some of the resources used by NRCS and also ask you what your "go-to" trick is.

8:30 AM

- 9:30 AM

DISTRICT MANAGER'S FORUM

Opportunity for District Managers to discuss DM-to-DM communication and coordination needs and opportunities. *Participation limited to District Managers.* Discussion will be facilitated by Jay Udelhoven, EMSWCD.

8:30 AM

- 10:45 AM

BEFORE THE FIRE: PLANNING & PREPAREDNESS (8:30-10:45)

Janine Salwasser-OSU Institute for Natural Resources, Boone Zimmerlee-ODF, Nancy Bush-Clackamas County Disaster Management, Scott West-ODF, Lisa Mahon-Wallowa SWCD and Loren Unruh-NRCS.

This suite of speakers will speak to wildfire planning and preparedness tools, resources and programs available to individual property owners and communities. Janine Salwasser will present The Oregon Explorer program's Oregon Wildfire Risk Explorer, which has partnered with the Oregon Department of Forestry and U.S Department of Agriculture, Forest Service to develop mapping and reporting tools to help homeowners, community members, and planners better understand their local fire environment around their home, in their watershed and county with new data available for Oregon. The data includes current wildfire risk, hazard to potential structures, historical wildfires, community group locations and more. In this session, the Oregon Wildfire Risk Explorer site and tools will be demonstrated.

Boone Zimmerlee will provide an organizational overview and discussion of how the Firewise Program empowers neighbors to work together in reducing the wildfire risks around their communities. Helping community members join together to be more proactive in wildfire preparation is what the Firewise Communities program is all about. The program provides you with benefits such as learning how to prepare a "defensible space" around your home and driveway. In these defensible areas, firefighters can more safely and effectively protect your home and property from a wildfire.

Nancy and Scott West will co-present on how the Oregon Department of Forestry - Molalla Unit and Clackamas County Disaster Management partner with the Coffee Creek Correctional Facility, an all-female inmate facility, to train and utilize inmates in fuel reduction and assist in

fire-fighting when called upon. This presentation will discuss funding, the training program, and the partnership for this project. This is ongoing program is one that Clackamas County fire districts can utilize as needed.

Lisa Mahon will provide a description/overview of Wallowa Soil and Water Conservation District programs focused on wildfire preparedness planning and prevention to landowners.

Loren Unruh will speak about the technical and financial sources of assistance from the U.S. Department of Agriculture Natural Resources Conservation Service for planning and implementation of forestry practices designed to prevent wildlife.

**8:30 AM
- 9:30 AM**

COVER CROPPING TO SUPPORT SOIL HEALTH IN WESTERN OREGON

Annie Young-Matthews and Nick Sirovatka, NRCS

The Corvallis PMC and Pullman PMC will grow out different examples of cover crop species and bring to CONNECT for hands on discussion of how to work cover crops into a cropping systems. Come see in real life examples of cover crop varieties and learn about their attributes and how they can help build healthy soil across Oregon.

**8:30 AM
- NOON**

INNOVATIVE APPROACHES TO OAK AND PRAIRIE CONSERVATION (8:30AM-NOON)

Tom Kaye-Institute of Applied Ecology, Marko Bey-Lomakatsi Restoration Project, Nicole Maness-Willamette Partnership, Nicole Ruggiero-Tualatin SWCD, Christian Seal-US Fish & Wildlife Service

This information sharing session is a continuation of Connect 2018 oak restoration session. Once again, the format will include number of presentations on the work of restoring oak habitats on private lands followed by a round table discussion. This year's focus will be new and exciting ideas and methodologies in the world of oak woodland/prairie restoration and conservation. Presentations will include oak prioritization mapping in the Metro area, the Oak Accord – a voluntary conservation agreement aimed at protecting oak habitat, innovative oak habitat restoration methods from USFWS, Lomakatsi Restoration Project and Institute for Applied Ecology.

Put Your Soil to the TEST with the...

SOIL YOUR UNDIES

Challenge



Join farmers and ranchers
across Oregon to uncover the secrets of
soil health with a shovel and a pair of cotton underwear.

Are **YOU** up to the challenge?

Find out more at:

bit.ly/soilundies

USDA is an equal opportunity provider, employer and lender.

CONNECT 2019 AGENDA

Room Name	Education & Outreach Heritage 1	Manager/Admin Heritage 2	Wildfire Landmark 1 and 2	Technology Homestead 1	Vegetation Homestead 2	Water Homestead 3	Meetings Abbot 1
3:00-6:00 PM	Monday April 8, 2019						
5:00-7:00 PM	SWCC Meeting						
Registration Desk Open							
Tuesday April 9, 2019							
7:00 AM-8:30 AM	Breakfast						
7:00 AM-11:00 AM	Vendor Setup						
8:00 AM-11:30 AM	Forestry and Meadow Field Trips Meet at Registration Desk to Carpool to Various Sites @ 7:45 AM						
8:00 AM-11:30 AM	Biochar						
12:00-1:00 PM	Lunch						
12:45 PM-1:15 PM	Welcome/Announcements/Partner Updates						
1:30-2:30 PM	Speed Networking	Records Retention with Panel Discussion	Catch the Bug	Connectivity Modeling for Conservation: The Oregon Connectivity Assessment and Mapping Project	Get Connected: Lessons shared from the PNW-Garlic Mustard Working Group	Coordinated Streamside Mgmt Program: OWEB, ODA and Partners	
2:45-3:45 PM	Outreach Mixer	Be the Boss of Your Email: Take Control of Your Inbox	Stories from California's Camp Fire	Utilizing Drones in Restoration	Strategies and Considerations for Successful Riparian Grazing	OWEB's Capacity Investments: Learning from the Past and Preparing for the Future	
4:00 PM-5:00 PM	OCEAN Annual Meeting						
5:00 PM - 5:30 PM	Soil Health Mfg						
5:30 PM - 6:30 PM	Dinner						
6:15 PM-9:00 PM	OACD Meeting						
Wednesday April 10, 2019							
7:00 AM - 8:30 AM	Breakfast						
8:30 AM - 9:30 AM	Your Outreach Plan--Tools, Tips and Tricks for Orchestrating a Successful Strategy	District Managers Forum (Participation limited to District Managers)	Before The Fire: Planning & Preparedness	Cover Cropping to Support Soil Health in Western Oregon	Innovative Approaches to Oak and Prairie Restoration	Improving Instream Habitat and Fish Passage for Coho & Steelhead in the Iconic Rogue River Basin	
9:45 AM - 10:45 AM	Outreach Beyond the News Release, Finding Your Core Message	Growing Organizational Capacity	When the Fire Gets Big- Part 1-Incident Command System 101	Cover Cropping to Support Soil Health in Eastern Oregon		An Overview of Harmful Algal Blooms in Oregon Rivers, Lakes, and Reservoirs	
11:00 AM - 12:00 PM		Using ORPIN for Purchasing and Building Solicitations		Climate Change in Oregon		Everybody Drinks! Tapping into Federal Partnerships and Funding for Drinking Water Source Watersheds	

Room Name	Education & Outreach	Manager/Admin	Wild fire	Technology	Vegetation	Water	Meetings
	Heritage 1	Heritage 2	Landmark 1 and 2	Homestead 1	Homestead 2	Homestead 3	Abbot 1
12:00 PM - 1:30 PM	Lunch						
1:30 PM - 2:30 PM	Leveraging the Power of Habit for Conservation	Government Relations: Toolkit and Panel of Advocates	When the Fire Gets Big - Part 2-What Actually Happened	Nutrient Management Planning Tool	Carbon Farming Workshop	Overview and hands-on Demonstration of DEQ's New Database AWQMS	NRCS All DC Meeting (Located in Abbot 1 in the Sunriver Lodge)
2:45 PM - 3:45 PM	Connecting with Everyone: Ways to Make Diversity a Positive Reality	Telling Ag's Story: Tracking Activities to Show Progress Towards Improving Water Quality	After The Fire: Recovery	Utilizing Avenza Maps for Conservation	Communicating Change: Engaging Land Managers in the Science and Practice of Adaptation	Strategies for Success when Seeking Water Supply Project Feasibility and Implementation Funding	
4:00 PM - 5:00 PM		Setting up a Conservation Lending Program		Riparian Condition Monitoring at Scale with Remotely Sensed Data		Irrigation Improvement Projects	
5:00 PM - 6:00 PM	Dinner						
6:00 PM - 7:30 PM	Sponsor Meet & Greet Reception in Great Hall Foyer						
7:00 AM - 8:30 AM	Breakfast						
8:30 AM - 9:30 AM	Social Falls and What We Can Learn From Them	To Boldly Go - Taking a Project from an Idea to a Grant Application	Wildfire-Before, During and After-Epilog Session	Preserving, Transferring & Affording Ag Land - An Exploration of a New, Statewide Organization	Prairie Restoration: A Look at the Role of Soil	Tide Gate Facilitated Discussion Session	
9:45 AM - 10:45 AM	Fearless Volunteer Management	I Need More Power! - A Project Becomes a Grant		Securing an OWEB Focused Investment Partnership Grant with the Help of Open-Source Technology	Pudding River Watershed Tree Project 2018	Overview of DSL Compensatory Mitigation Framework & Habitat Restoration Project Permitting Options	
11:00 AM - 12:00 PM	Going Deeper Into Instagram and Instagram Stories	Live Long & Prosper - Wrapping up and Monitoring a Project	Going Digital...Effective Conversion from Paper to Field Data Collection	ODA and All Things Hemp	Large-Scale Floodplain Restoration		
12:00 PM - 1:00 PM	Lunch						
12:00 PM - 1:00 PM	Unlocking the Power of Habit						



EARTH SCIENCE AND ENGINEERING SERVICES



www.aspectconsulting.com
541.306.3623
Contact us to learn more

Water Resources
Managing a scarce resource

Geological & Geotechnical Engineering
Creating stable conditions in sensitive areas

Remediation Engineering
Restoring productive land use

Stormwater
Protecting our water quality

Data + Mapping
Information that tells a story

Bainbridge Island • Bellingham • Bend • Portland • Seattle • Wenatchee • Yakima



58640 McNulty Way
St. Helens, Oregon 97051

Phone: (503) 366-0399
www.lowercolumbiaengr.com

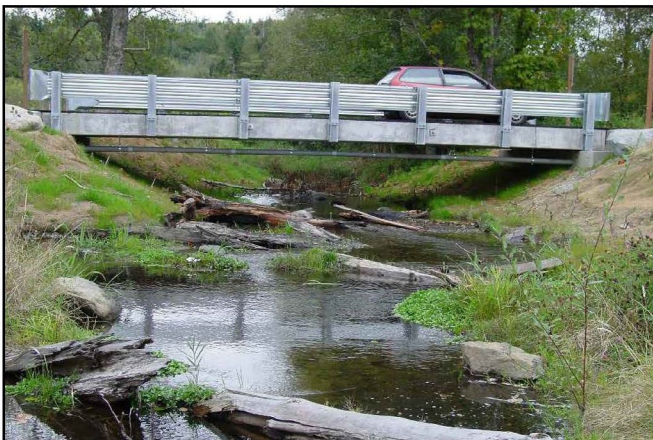

engineering • surveying • natural resources

Engineering for:

<i>River/Stream Restoration</i>	<i>Permitting Assistance</i>
<i>Fish Passage</i>	<i>Archaeological Services</i>
<i>Water Resources</i>	<i>GIS Services</i>
<i>Drinking Water</i>	<i>Stormwater</i>
<i>Wastewater</i>	<i>Site Development</i>
<i>Roads</i>	<i>Irrigation</i>
<i>Bridges</i>	<i>Survey</i>

La Grande, Oregon
(541) 963-6309

Walla Walla, Washington
(509) 529-9260

Redmond, Oregon
(541) 362-8682

www.andersonperry.com



Over 30 years of experience in providing specialized and affordable insurance services for Oregon's special districts.



SDIIS Special Districts Insurance Services

Contact us today to learn why the majority of Oregon's special districts choose SDIS for their coverage needs.

Toll-Free: 800-285-5461
Web: www.sdao.com

SDIIS
SPECIAL DISTRICTS
INSURANCE SERVICES

**8:30 AM
- 9:30 AM**

IMPROVING INSTREAM HABITAT & FISH PASSAGE FOR COHO & STEELHEAD IN THE ICONIC ROGUE RIVER BASIN

Alexis Larsen, Rogue River Watershed Council

Alexis Larsen, project manager for the Rogue River Watershed Council, will discuss the partnerships and processes that led to the implementation of instream and fish passage projects that have opened access to over 5 miles of spawning and rearing habitat, improved 1.5 miles of instream habitat with large wood placement, and restored over 18 acres of riparian habitat. Development of these projects required partnerships with federal, state, and county agencies, landowners and water users, and local municipalities. These partnerships are important not only for implementation of restoration projects but for project development and design, permitting, contracting, monitoring, and reporting. Alexis will discuss how all the pieces of project management fit together with a variety of partnerships, how to determine a project timeline to meet deadlines, how to manage multiple partnerships, and how strong collaboration can lead to successful restoration projects.

**9:45 AM
- NOON**

OUTREACH BEYOND THE NEWS RELEASE, FINDING YOUR CORE MESSAGE (9:45-NOON)

Matt Shelby, Oregon Lottery

In this session, we will help you write your organization's core message. We will then help you expand that core message into:

- Public Service Announcements (PSAs) for TV and radio
- Elevator speeches that your key stakeholders can deliver
- Other marketing materials to help increase awareness of your organization

**9:45 AM
-10:45 AM**

GROWING ORGANIZATIONAL CAPACITY

Bala Cadambi, BEF

Oregon has an abundance of Watershed Councils, Soil and Water Conservation Districts and Land Trusts that dovetail in partnerships to serve their communities. Many have gained significant independent capacity in essential areas: their sense of place, relevance of mission, congruence of practices, regional partnerships, science data and accumulated wisdom. On the other hand, capacity gaps remain to be addressed, especially for smaller organizations, where reserves may be drawn down, funding mix restricted, board engagement limited in areas and not all constituencies may be equitably represented or find services accessible.

While this session is based on experience working with Mid-Willamette Watershed Councils, the observations are germane with suitable moderation to Oregon-wide WCs, SWCDs and LTs. The presentation will start with a framework to examine the overall balance of organizational capacities within relevant structural constraints and areas of operational flexibility. Specific opportunities in the areas of shared or outsourced services, improved collaboration, brand enhancement, community engagement and funding flexibility will then be explored. Recommendations will focus on essential tradeoffs for addressing capacity gaps towards the twin goals of gaining organizational resilience along with program flexibility.

9:45 AM
-10:45 AM

COVER CROPPING TO SUPPORT SOIL HEALTH IN EASTERN OREGON

Annie Young-Matthews and Nick Sirovatka, NRCS

The Corvallis PMC and Pullman PMC will grow out different examples of cover crop species and bring to CONNECT for hands on discussion of how to work cover crops into a cropping systems. Come see in real life examples of cover crop varieties and learn about their attributes and how they can help build healthy soil across Oregon.

9:45 AM
-10:45 AM

AN OVERVIEW OF HARMFUL ALGAL BLOOMS IN OREGON RIVERS, LAKES, AND RESERVOIRS

Dan Sobota and Julie Harvey, Oregon DEQ

Harmful algal blooms (HABs) occur when single-celled aquatic plants grow excessively. In freshwaters throughout Oregon, HABs caused by cyanobacteria (CyanoHABs) are of particular concern because these events can produce compounds toxic to humans, pets, livestock, wildlife, and aquatic life. These events can also cause “dead zones” (very low oxygen levels) through the process in which decomposing organism consume dead algae on the bottoms of waterbodies. Thus, CyanoHABs significantly impact the availability of drinking water, recreational opportunities, fisheries resources, agricultural products, and aquatic habitat in Oregon.

For this presentation, we will provide an overview of CyanoHABs across Oregon. This will include the history of CyanoHAB events in Oregon, factors that can lead to CyanoHABs in waterbodies, and the process by which government agencies across the state respond to CyanoHAB events. We will highlight several recent CyanoHAB events as part of this presentation and discuss resources available to local communities to address CyanoHABs. We will conclude with recommendations for how to improve monitoring and management of CyanoHABs in Oregon waterbodies.

11:00 AM
- NOON

UTILIZING ORPIN FOR PURCHASING AND BUILDING SOLICITATIONS

Adam Helvey, Oregon Department of Administrative Services

This session will focus on how to use the Oregon Procurement Information Network (ORPIN) :

- As a research tool with examples and templates to help you build solicitations such as RFP's and ITB's
- As an advertising tool for posting your opportunities
- Locating price agreements for purchasing products and services at the State of Oregon pricing and terms and conditions
- To find suppliers for a three-quote process

**11:00 AM
- NOON**

WHEN THE FIRE GETS BIG – PART 1 – INCIDENT COMMAND SYSTEM 101

Russ Lane, ODF

Russ will go over the fundamental structure to an Incident Command Team deployed to a large fire incident and how best to interact with that Team during the course of wildfire fighting effort. Russ will discuss the responsibilities of the Incident Command Team prior to leaving a wildfire incident. This session details what is supposed to happen when an Incident Command Team descends on a community to fight a large wildfire.

**11:00 AM
- NOON**

CLIMATE CHANGE IN OREGON

Kathie Dello, Oregon Climate Change Research Institute

Climate change is impacting Oregon's natural resources, economy and way of life. This session will give an overview of the current scientific understanding of climate change and the likely impacts to expect into the future, with an emphasis on agriculture and forestry.

**11:00 AM
- NOON**

EVERYBODY DRINKS! TAPPING INTO FEDERAL PARTNERSHIPS AND FUNDING FOR DRINKING WATER SOURCE WATERSHEDS

Mary Beth Smith-Oregon NRCS, Scott Lightcap - BLM, and Julie Harvey – Oregon DEQ

Learn how to tap into resources for the restoration and protection of watersheds that supply drinking water. This session presents information on several programs that support activities like soil conservation, riparian restoration, road improvements, and in-stream work, which will benefit water quality and public health protection. NRCS-Oregon will provide information on their programs including the expansion of the FY2019 National Water Quality Initiative to address surface and groundwater sources of drinking water. In this new Source Water Protection Pilot, NRCS will work with local partners of selected projects to tackle agricultural-related impacts to water quality. In its first year, the Pilot will focus on the improvement or development of watershed/aquifer protection assessments or action plans. Subsequent years of work can include accelerated financial assistance to implement the action plans. The Drinking Water Providers Partnership is a collaboration with USFS, BLM, EPA, Oregon and Washington's drinking water programs and several NGOs that directs financial and technical assistance to voluntary conservation and restoration projects in municipal watersheds across the Northwest. In addition, Oregon DEQ will provide information on Clean Water and Drinking Water State Revolving Fund sources.

**NOON
-1:30 PM**

LUNCH

Join us in the Great Hall for lunch and some words from our partners.

**1:30 PM
- 2:30 PM**

LEVERAGING THE POWER OF HABIT FOR CONSERVATION

Jennifer Nelson, Washington County

As conservation educators, we often design education based on the assumption that if people just knew better, they'd do better. Yet time and again, we deliver thoughtful, compelling presentations and workshops that don't amount to much change. Ever wonder what's going on there? Research in the field of brain function, psychology and human behavior offers some clues as to why habits may be the stumbling block. In this session, learn more about how the brain stores information, makes new decisions, and relies on habits for routine actions. You'll receive ideas for how to build habit change into your workshops and programs while learning how Washington County's Sustainability Program uses this information to empower employees to successfully change the habits of their choice. Bonus: learn to play Participation Poker, an excellent workshop engagement strategy that is fun and easy to adapt to any content!

**1:30 PM
- 2:30 PM**

GOVERNMENT RELATIONS: TOOLKIT AND PANEL OF ADVOCATES

Bill Lehmen- Klamath Watershed Partnership, Stan Dan-Jackson SWCD and Advisory Council for the Southern Oregon Research and Extension Service Land Steward Program, Commissioner Margaret Magruder-Columbia County Commissioner

In this session, the new Oregon Conservation Partnership "Government Relations Toolkit" will be introduced, followed by a discussion of good government relations practices will be led by a panel. The panelists each have experience advocating from a special district or watershed council perspective. In addition, Commissioner Margaret Magruder has extensive experience in local government and is an ally for natural resource conservation in her position as Columbia County Commissioner, including by serving on the statewide Tide Gate Partnership Steering Committee. Panelists will share an example and/or highlight best practices from their experience, then welcome questions and discussion with the audience.

Panelists:

- Bill Lehmen, Executive Director of the Klamath Watershed Partnership.
- Stan Dan, At-Large Director at Jackson SWCD and member of the Advisory Council for the Southern Oregon Research and Extension Service Land Steward Program.
- Commissioner Margaret Magruder, Columbia County Commissioner and former coordinator of the Lower Columbia River Watershed Council. Commissioner Magruder has also served as a member of advisory committees on the Columbia County budget and on Clatskanie-Quincy planning, and serving on the Columbia School District 5J board of directors.

**1:30 PM
- 2:30 PM**

WHEN THE FIRE GETS BIG – PART 2 – WHAT ACTUALLY HAPPENED

Shilah Olson-Wasco SWCD and Robert Wallace-WyEast RC&D

Shilah and Robert will share their personal and professional experience with a large wildfire incident in Wasco County including lessons learned and what they wish they knew ahead of time before entering this experience.

1:30 PM
- 2:30 PM

NUTRIENT MANAGEMENT PLANNING TOOL

Tom Thomson, NW Ag Consulting and Bruce Wilson, H&R Engineering

Improper applications of inorganic and organic forms of nitrogen and phosphorus on agricultural fields can lead to pollution of surface and ground water sources from excesses of these nutrients contained in surface runoff and leachate in soil water. In an attempt to reduce these pollutants, especially in organic forms, legislation has been passed that requires farmers to document the amounts of nitrogen and phosphorus that they apply and what is utilized by the crops they grow. The Nutrient Management Planning Tool (NMPT) will provide a simple to use internet-based record keeping and planning tool that will allow farmers to easily document the amount of nutrients, specifically nitrogen, phosphorus and potassium, which are applied to fields and removed in the crops being grown. NMPT will also allow the user to generate various types of reports, e.g. whole farm nutrient balance, to document historical and current nutrient applications and utilization.

NMPT is free to use and all information stored on the NMPT website is kept confidential. The NMPT website can be accessed by logging into <https://nmpt.online/>.

1:30 PM
- 3:45 PM

CARBON FARMING WORKSHOP (1:30 PM-3:45 PM)

Dr. Jeff Creque-CCI, Lynette Niebrugge-CCI, Torri Estrada-CCI, Patricia Hickey-Washington Association of Conservation Districts

Using a Carbon Farming framework, working lands can sequester additional carbon to improve soil health, biodiversity and wildlife habitat, and increase productivity and resilience to climate change, including drought. This workshop will present the scientific and applied basis for Carbon Farming; how to quantify GHG benefits; and how to develop a Carbon Farm plan. We will also present policies and programs for carbon farming in CA and WA, and the CA carbon farming experience of Organic Valley.

This session will focus on the science and practice of engaging natural resource managers on the topic of climate change. The session will focus on strategies for engaging producers in climate adaptation by linking them to existing conservation and planning efforts. Regional tools and resources designed to improve climate decision-making will also be shared. Participants who attend this session will be encouraged to think about how they can better integrate knowledge regarding the impacts and consequences of climate change in their work with producers. Participants will hopefully leave the session empowered with more tools for communicating and engaging their clientele on the topic of climate change and its associated impacts.

4-10-19

WEDNESDAY, APRIL 10TH

**1:30 PM
- 2:30 PM**

OVERVIEW AND HANDS-ON DEMONSTRATION OF DEQ'S NEW DATABASE AWQMS

Dan Brown, Oregon DEQ

During the summer of 2017, DEQ launched a new public facing database called the Ambient Water Quality Monitoring System, or AWQMS. This new database replaced the aging LASAR database, with a single intuitive database capable of consolidating, assessing and sharing sampling results. Over the nearly two years since the launch, laboratory staff have been diligently preparing data from the previous system for upload to AWQMS, querying data from WQX, and creating tutorials to make using the new database easy and straightforward. In this presentation, I will review the data currently housed in AWQMS, such as volunteer monitoring, TMDL data, and ambient monitoring, the best ways to query data, how to use the assessment tools provided in AWQMS, as well as what to expect in the future. The session will include ample time for demonstration and hands on use with DEQ employees available to answer questions and provide advice.

**2:45 PM
- 5:00 PM**

CONNECTING WITH EVERYONE: WAYS TO MAKE DIVERSITY A POSITIVE REALITY (2:45-5:00)

Frances Portillo, Portillo Consulting

Participants will be invited to share what they have done to reach out to diverse communities and tell about their successes and challenges. Culture and Diversity are concepts that need to be defined in a way that everyone is on the same page. From there, organizations can move to truly implementing programs that reach everyone in a way that is meaningful and inspires success.

The session will start with a focus on cross-cultural communication and the way we speak to each other. We will then move to the organizational skills that are needed for positive workplace environment as well as community engagement.

This can be intriguing and exciting. Let's explore together in ways that are positive and stimulate creative and useful approaches.

**2:45 PM
- 3:45 PM**

TELLING AG'S STORY: TRACKING ACTIVITIES TO SHOW PROGRESS TOWARDS IMPROVING WATER QUALITY

Ellen Hammond, ODA

Meeting the goals of Oregon's Agricultural Water Quality Program is a 4-step process: 1) assisting landowners 2) supports on-the-ground work, 3) which improves landscape conditions 4) that improve water quality.

Agricultural Water Quality Management Area Plans have been the main vehicle for reporting assistance and on-the-ground activities for 20 years, relying primarily on quarterly Scope of Work reports submitted by SWCDs. However, these reports are just part of the picture, and the process of telling a more complete story has been challenging for all involved.

An ODA workgroup has been refining data needs for reporting activities to show progress to all interested parties. The workgroup identified key audiences and developed a suite of activities to report on. We need your help to see if we are on the right track. We will present our proposal during this session. Please attend to evaluate our work and provide comments and recommendations so that ODA is better prepared to tell your story in the upcoming biennium.

2:45 PM
- 5:00 PM

AFTER THE FIRE: RECOVERY (2:45-5:00)

DO OR DO NOT, THERE IS NO TRY - REAL CONSERVATION DISTRICT EXPERIENCE WITH POST WILDFIRE RECOVERY

Craig Nelson, Okanogan Conservation District

Craig manages the Okanogan Conservation District in Washington State. Craig will present about their experiences assisting landowners, agencies, and entire communities with fire recovery through back-to-back record-breaking wildfire seasons. Craig will offer insights into the myriad of activities his District accomplished through innovative partnerships, broad community and statewide support, and sheer determination. He will describe the first-ever state and private lands BAER Team creation, post-wildfire flood mitigation measures, direct landowner assistance to hundreds of landowners in a matter of months, and processing of millions of dollars of cost-share to offset damages. Participants will gain insights into activities and tasks they may be called upon to perform to assist individual landowners, partner agencies, and communities with wildfire recovery.

OREGON SILVER JACKETS: FLOOD RISKS AFTER A WILDFIRE PLAYBOOK

Ryan Cahill, US Army Corps of Engineers

The Oregon Silver Jackets team is an interagency group that addresses flood risk issues across the state. A brief overview of the Oregon Silver Jackets team will be given. The primary area of emphasis in 2018 was the development of a post-wildfire flood playbook. Large wildfires are an increasing issue in Oregon, likely becoming more frequent and severe in the future. Oregon has not experienced any catastrophic floods in burned areas yet, but this is an area of significant risk for the state, and neighboring states have experienced major damage from these issues in the recent past. An interagency playbook has been completed to prepare for flood threats after wildfires. The guide contains resources for local communities to address increased flood risk and debris flows that can occur after large wildfires.

SOURCES OF ASSISTANCE PANEL

Ryan Gordon-ODF, Jay Gibbs-NRCS

Ryan Gordon will speak about the technical and financial sources of assistance available from the Oregon Department of Forestry. Ryan will also speak about the financial and technical assistance available through the FSA's Emergency Forest Restoration Program and the Agriculture Emergency Restoration Program. Jay Gibbs will speak about the technical and financial sources of assistance available from NRCS for post-wildfire recovery on private agricultural, range and forest land.

2:45 PM
- 3:45 PM

UTILIZING AVENZA MAPS FOR CONSERVATION

Kyle Waggoner, Umatilla SWCD

This class will focus on an introduction to the Avenza map app for both iPhone and Android. Topics include basic app navigation, map acquisition, and how to utilize tools within the app to accurately plot points, geotag photos, measure, and record GPS tracks. Time will also be spent on data analysis and transfer to PC mapping systems, including ArcGIS

2:45 PM
- 3:45 PM

STRATEGIES FOR SUCCESS WHEN SEEKING WATER SUPPLY PROJECT FEASIBILITY AND IMPLEMENTATION FUNDING

Kim Ogren, Water Resources Department

In this session we will learn about the Oregon Water Resources Department's funding opportunities and strategies for preparing a successful application. The Water Resources Development Program provides funding opportunities to help individuals and communities address instream and out-of-stream water supply needs. Feasibility Study Grants fund up to 50% of costs to evaluate the feasibility of water conservation, reuse and storage projects. Water Project Grants and Loans provide funding for instream and out-of-stream water supply projects that result in economic, environmental, and social/cultural public benefits. Develop an understanding of these funding opportunities and learn how early planning and other strategies can improve your study/project proposal and application.

4:00 PM
- 5:00 PM

SETTING UP A CONSERVATION LENDING PROGRAM

Eann Rains, Clackamas SWCD and Lee Ann Lawrence, Oregon DEQ Clean Water State Revolving Fund

When implementing on-the-ground conservation, one of the biggest challenges landowners, SWCDs, and partners face is identifying funding, particularly for up-front expenses. The Oregon Dept. of Environmental Quality (DEQ) offers several types of loans to public entities through the Clean Water State Revolving Fund (CWSRF). Within the CWSRF program, the Local Community Loan option provides low-interest financing to SWCDs and other public entities that use these funds to make loans to private landowners for nonpoint source projects that prevent or mitigate water pollution. Clackamas SWCD has used LCL loans to finance its own loan program, providing cash flow to landowners for such practices as irrigation efficiency improvements, livestock heavy use areas, manure composting facilities, and residential septic system repairs, and for the purchase of conservation-related farm equipment. This presentation will give an overview of the Clean Water SRF Local Community Loan program and will describe in practical terms how Clackamas SWCD has used this source of funding (and other revenue) to establish a revolving loan fund to make loans to private landowners.

4:00 PM
- 5:00 PM

RIPARIAN CONDITION MONITORING AT SCALE WITH REMOTELY SENSED DATA

Ray Brunner, Institute for Natural Resources

We make riparian vegetation maps based on field data and free imagery sources (e.g., the Oregon statewide imagery program, Landsat and Sentinel-2 satellite sensors) that are valuable tools for evaluating success in conservation and restoration. On-the-ground monitoring of riparian conditions is a crucial component of many programs, but it can be difficult to scale up from field observations to metrics that directly relate to program goals at the level of the reach or watershed. Riparian areas are also in flux, the temporal dynamics of riparian condition can be difficult to understand when field data is collected sporadically and over only a small fraction of all riparian areas. We demonstrate that remote sensing-based modeling provides a valuable tool for addressing both challenges, and can give spatial context to make field data more relevant for assessment and decision making. In this presentation I'll talk about past successes that we've had mapping riparian condition in Oregon and some of the cool things that we hope to achieve in the future.

4:00 PM
- 5:00 PM

COMMUNICATING CHANGE: ENGAGING LAND MANAGERS IN THE SCIENCE AND PRACTICE OF ADAPTATION

Gabrielle Roesch-McNally, USDA Northwest Climate Hub

This session will focus on the science and practice of engaging natural resource managers on the topic of climate change. The session will focus on strategies for engaging producers in climate adaptation by linking them to existing conservation and planning efforts. Regional tools and resources designed to improve climate decision-making will also be shared. Participants who attend this session will be encouraged to think about how they can better integrate knowledge regarding the impacts and consequences of climate change in their work with producers. Participants will hopefully leave the session empowered with more tools for communicating and engaging their clientele on the topic of climate change and its associated impacts.

4:00 PM
- 5:00 PM

IRRIGATION IMPROVEMENT PROJECTS

Paul DeMaggio, PE, CAIS, CID – Jackson SWCD

Water Quality and Quantity Evaluation at the Watershed Scale, Irrigation BMPs, and Case Studies from Southern Oregon.

5:00 PM
- 6:00 PM

Sponsor Meet & Greet

Socialize with colleagues and visit every sponsor table!

6:00 PM
- 7:30 PM

Banquet

Enjoy Dinner in the Great Hall while connecting with fellow conservation enthusiasts and hearing from our partners.

7:00 AM

BREAKFAST

8:30 AM

Join us in the Great Hall for breakfast.

8:30 AM

SOCIAL FAILS AND WHAT WE CAN LEARN FROM THEM

- 9:30 AM

Jarrod Lyman, Clackamas County Tourism & Cultural Affairs

With so many brands turning to social media for their marketing efforts, it's only inevitable that there will be some missteps. We'll examine some of the funniest, most cringe-worthy, and outright horrific errors made by brands, and identify steps we can take to ensure we never end up on a list like this.

8:30 AM

YOUR OWEB GRANT FROM START TO FINISH (8:30-NOON)

- 9:30 AM

This three-session block will provide participants with the know-how to take an idea all the way from project development, to successfully obtaining an OWEB grant, and managing the project through completion and monitoring. Workshop content is geared toward project managers working within the Open Solicitation grant program but can be useful for anyone working with OWEB funding who wants to confidently and efficiently navigate the process. Along the way, there will be plenty of time for Q & A and audience participation. The three sessions are:
 Session 1: TO BOLDLY GO- TAKING A PROJECT FROM AN IDEA TO A REALITY
 Session 2: I NEED MORE POWER! – A PROJECT BECOMES A GRANT
 Session 3: LIVE LONG & PROSPER – WRAPPING UP AND MONITORING A PROJECT

TO BOLDLY GO- TAKING A PROJECT FROM AN IDEA TO A REALITY**Sue Greer, Reed Warner, Tara Choate, Liz Redon, OWEB**

What to do when you have an idea for a project? This session will provide the tools to take a project from an idea to a grant application, and help you navigate the OWEB application process along the way. Topics will include project development strategy, OWEB's online application system, budget development, and tips for success in the review process.

8:30 AM

WILDFIRE – BEFORE, DURING AND AFTER – EPILOG SESSION (8:30

-10:45 AM

AM – 10:45 AM)**Craig Nelson-Okanogan Conservation District, Clint Nichols-Jackson SWCD**

Come join us for a facilitated discussion on how SWCDs, watershed councils and land trusts can be better prepared, engaged with suppression efforts and assist in recovery from wildfire. Session champions Jeremy Baker-East Multnomah SWCD (Before the Fire), Jim Cathcart-West Multnomah SWCD (When the Fire Gets Big) and Tom Salzer-Clackamas SWCD (After the Fire) will summarize what was learned for those that were not able to attend those sessions. Clint Nichols-Jackson SWCD will prime the discussion by sharing Jackson Soil and Water Conservation District's experience with the Peninger Fire in southern Oregon - specifically with after the wildfire recovery and restoration of riparian habitat along Bear Creek (a tributary of the Rogue River). The session will then invite conversation from the audience on lessons learned and possible roles and actions, including questions to be answered.

8:30 AM
- 9:30 AM

PRESERVING, TRANSFERRING & AFFORDING AG LAND – AN EXPLORATION OF A NEW, STATEWIDE ORGANIZATION

Nellie McAdams-Consultant, Jay Gibbs-NRCS, & Sarah Beaubien-Tillamook Dairy Co-op

Farm and ranch businesses depend on agricultural land, as do rural communities and fish and wildlife habitat. Yet Oregon's ag land is threatened. Almost two-thirds of Oregon ag land will change hands in the next 20 years and most farmers and ranchers do not have a succession plan. Without a plan, ag land is more likely to be fragmented, converted or sold to non-farmers like investment companies. While Oregon's land use laws slow the pace of development, they do not offer permanent protection. And the impacts spread to the community - when ag land is lost, surrounding farms and ranches suffer.

In early 2018, an initiative began to explore how to increase ag land preservation in the Willamette Valley. One large convening and several smaller meetings later, the project has expanded to exploring how to increase ag land preservation, transfer, and affordability throughout the state. Come hear the findings from recent gap analyses and conversations with other states' land trusts, learn about the work of a leadership team, and give your feedback on a new organization that can help fill gaps and provide support in this area.

8:30 AM
- 9:30 AM

PRAIRIE RESTORATION: A LOOK AT THE ROLE OF SOIL

Teresa Matteson, Benton SWCD

What role does soil play in the success or failure of upland prairie habitat restoration? From 2016 to 2018, Benton SWCD worked with soil scientists, botanists, and GIS consultants to compare the soil characteristics of upland prairie remnants and restoration sites. Learn how human activities have influenced these unique ecosystems over time. Hear the story of a project, rich in human resources, that focused underground to help an endangered little blue butterfly.

8:30 AM
- 9:30 AM

TIDE GATE FACILITATED DISCUSSION SESSION

Moderator: Melaney Dunne, Coquille Watershed Association

This session will be facilitated as a discussion among attendees to share information regarding ongoing tide gate projects and initiatives along the coast and to share updates and feedback on the statewide Tide Gate Partnership initiative. For more information on the tide gate issue and statewide Tide Gate Partnership please go the website: www.oregontidegates.org. This session provides an opportunity to learn from each other on the design and implementation of tidegate related projects and how they are funded. The outcome of this session is to 1) obtain a shared understanding of what needs councils and districts have to ensure the streamlined implementation this important work and 2) facilitate a network of individuals and organizations that can support and share information on tide gate replacement projects after the conference.

9:45 AM
-10:45 AM

FEARLESS VOLUNTEER MANAGEMENT

Amy Ludholz, Evergreen Habitat for Humanity

Tips and tools for learning how to recruit, retain, and recognize volunteers who do so much for your organization.

9:45 AM
-10:45 AM

I NEED MORE POWER! – A PROJECT BECOMES A GRANT

Katie Duzik, Tara Choate, Greg Ciannella, and Mark Grenbemer, OWEB

Your project has been awarded a grant- congratulations! But, now what? This session will help you answer that question and successfully implement your project while navigating the OWEB funding process efficiently. Topics to be presented include contract development, submitting successful fund requests, progress reporting, budget amendments, and scope of work changes.

9:45 AM
-10:45 AM

SECURING AN OWEB FOCUSED INVESTMENT PARTNERSHIP GRANT WITH THE HELP OF OPEN-SOURCE TECHNOLOGY

Cheryl McGinnis-Clackamas River Basin Council, John Runyon- Cascade Environmental Group, and John Burns-Sitka Technology Group

The Clackamas Partnership was recently awarded an \$8.7m grant through the Oregon Watershed Enhancement Board's (OWEB) Focused Investment Partnership (FIP) program. The grant supports comprehensive fish habitat restoration, outreach, monitoring, and other activities over a six-year investment period starting in 2019 and ending in 2025.

The Clackamas Partnership, a collaboration of over 15 Portland Metro area watershed councils and government agencies, has been using an open-source online platform for restoration project development and to track performance metrics that measure improvements in watershed health in the Clackamas River Basin, Johnson Creek, and other urban streams. The Project Tracker has proven to be an important tool for project planning and implementation. Since its launch in 2016, the online tool has provided an efficient and transparent platform for engaging the restoration partners, land owners, and public. The application provides a wealth of information about current, completed, and proposed projects across the region. Program details can be evaluated at a range of spatial scales and queried for details on limiting factors addressed, focal fish species impacted, performance measures, funding sources, and more.

The panel will discuss how they developed their winning grant proposal with an emphasis on the role technology played in the process.

9:45 AM
-10:45 AM

PUDDING RIVER WATERSHED TREE PROJECT 2018

Anna Rankin, Pudding River Watershed Council

The Tree Project 2018 session will explore a grassroots partnership that empowered private landowners in and around the watershed to plant roughly 3,000 trees of various species for free. The origin of the project was altruistic and opportunistic. As the project evolved, it became clear that the Tree Project model can be replicated in many watersheds for future landowner engagement, partnership participation, and restoration on a shoestring budget.

9:45 AM
-10:45 AM

OVERVIEW OF DSL COMPENSATORY MITIGATION FRAMEWORK & HABITAT RESTORATION PROJECT PERMITTING OPTIONS

Heidi Hartman-DSL and Sara Christensen-Oregon DEQ

High level overview of the new Compensatory Mitigation Framework in relation to wetland and stream functional assessments and when they may be required. Presentation will mainly focus on different permitting pathways for habitat restoration projects.

DEQ will present information regarding the 401 Water Quality Certification program. This will include information on Section 401 of the Clean Water Act, and Oregon Administrative Rules. We will discuss what triggers a 401, what types of information is needed for certification, fees, and program updates, including Nationwide and Individual certifications.

**11:00 AM
-NOON**

GOING DEEPER INTO INSTAGRAM AND INSTAGRAM STORIES

Jarrold Lyman, Clackamas County Tourism & Cultural Affairs

Social media landscape is continually changing. One of the developing trends we can take advantage of is using Instagram stories to tell your story. We'll look at this and other things you can do on Instagram and the ever-present Facebook.

**11:00 AM
-NOON**

LIVE LONG & PROSPER – WRAPPING UP AND MONITORING A PROJECT

OWEB Staff: Tara Choate, Katie Duzik, Greg Ciannella, and Mark Grenbemer

Your project has been completed and the dust is settled, and it's time to close out your project and enter the monitoring phase. This session will provide the tools to navigate that stage of the process with finesse and provide important resources on monitoring and reporting. Topics to be presented include: filling out successful Project Completion Report and monitoring reports that gets approved the first time, completing a final fund request, and the ins and outs of photopoint monitoring.

**11:00 AM
-NOON**

GOING DIGITAL...EFFECTIVE CONVERSION FROM PAPER TO FIELD DATA COLLECTION

Robyn Pepin and John Warinner, Aspect Consulting

Over the past decade or two, technological advancements have presented opportunities to streamline field data collection. However, migrating field staff to a paperless workflow requires more than choosing the right software and hardware. In this session, we will share our lessons and tips to effectively and efficiently migrate field staff to a paperless workflow. Our success has been achieved by choosing mission-appropriate software and hardware, and developing standard data structures and operating procedures for adoption by all field staff. In addition to defining SOPs, we will highlight reporting techniques to quickly harvest data collected in the field to create organizational operational awareness. We will highlight key areas to be successful in your organization:

1. Commercial off-the-shelf software for data collection
2. Hardware selection and standardization
3. Field data collection standard operating procedures
4. Reporting and operational awareness techniques

**11:00 AM
-NOON**

ODA AND ALL THINGS HEMP

Sunny Summers, ODA

What role does the Oregon Department of Agriculture play in the Oregon cannabis industry? Marijuana, hemp? Food safety? Ag water quality? Pesticide use? Come join us to get a broad overview of these areas and all things hemp. It's not just rope anymore folks!

4-11-19 THURSDAY, APRIL 11TH

11:00 AM -NOON **LARGE-SCALE FLOODPLAIN RESTORATION**

Matt Blakeley-Smith, Greenbelt Land Trust

Large-scale restoration projects don't have much room for trial and error. Unfortunately, projects failures are still far too common, and we have many lessons to learn from one another. For large-scale projects the stakes are higher and the techniques that are used on smaller projects often don't scale-up properly. This presentation will address how we can adapt methods from agriculture and forestry to our unique field of habitat restoration. Specifically, we will address precision agricultural techniques, economic scaling, preemergent herbicides, and maintenance. We'll also spend time discussing the emerging use of drones for project management.

NOON **LUNCH**

-1:00 PM Enjoy this year's last meal together in the Great Hall.

NOON **UNLOCKING THE POWER OF HABIT(Grab your lunch and take it to Heritage Room)**

-1:00 PM **Jennifer Nelson, Washington County**

Have you ever struggled to change an old habit or start a new one? From time tested techniques to cutting edge research on how our brains work, this training is full of information to help you get there. We will break down what a habit is, how it works in the brain, and what the best tricks for changing it are. During this class, start working on a habit you want to change and take home a plan to get started. (This workshop is a follow up to the "Motivating People to Change Habits" session on Wednesday and demonstrates one way to use those skills to educate others. Join us to see the concept in action, or just to learn more about changing personal or professional habits. It is not a repeat of the Wednesday session.)

Thank you to Our Speakers!

Adam Helvey, Oregon DAS
Alexis Larsen, Rogue River Watershed Council
Amy Ludholz, Evergreen Habitat for Humanity
Anna Rankin, Pudding River Watershed Council
Annie Young-Mathews, USDA-NRCS
Bala Cadambi, BEF
Bethanne Kronick, SIMPLIFY!
Bill Lehmen, Klamath Watershed Partnership
Boone Zimmerlee, ODF
Bruce Wilson, H&R Engineering
Cheryl McGinnis, Clackamas River Basin Council
Christian Seal, US Fish & Wildlife Service
Christine Buhl, Oregon Department of Forestry
Claire Phillips, USDA Agricultural Research Service
Clint Nichols, Jackson SWCD
Courtney Shaff, OWEB
Craig Nelson, Okanogan Conservation District
Dan Brown, OR DEQ
Daniel Sobota, Oregon DEQ
Drew Harper, Curry County SWCD
Eann Rains, Clackamas SWCD

Ellen Hammond, ODA
Eric Nusbaum, ODA
Frances Portillo, Portillo Consulting
Gabrielle Roesch-McNally, USDA Northwest Climate Hub
Greg Ciannella, OWEB
Heidi Hartman, Oregon Department of State Lands
Herb Winters, Gilliam SWCD
Janine Salwasser, OSU Institute for NR
Jarrod Lyman, Clackamas County Tourism & Cultural Affairs
Jay Gibbs, USDA NRCS
Dr. Jeff Creque, Carbon Cycle Institute
Jennifer Nelson, Washington County
John Burns, Sitka Technology Group
John Byers, ODA
John Runyon, Cascade Environmental Group
John Warinner, Aspect Consultingw
Julie Harvey, Oregon DEQ
Kathie Dello, Oregon Climate Change Research Institute
Kathy Ferge, USDA NRCS
Katie Duzik, OWEB

Kelpie Wilson, Wilson Biochar Associates
 Kevin Payne, Morrow SWCD
 Kim Ogren, Water Resources Department
 Kristin Trippe, USDA Agricultural Research Service
 Kyle Waggoner, Umatilla SWCD
 Lee Ann Lawrence, Oregon DEQ
 Liesl Coleman, Curry County SWCD
 Lindsey Karr, Clackamas SWCD
 Lisa Mahon, Willamette SWCD
 Liz Redon, OWEB
 Loren Unruh, NRCS
 Lynette Niebrugge, Carbon Cycle Institute
 Margaret MaGruder, Columbia County Commissioner
 Mark Grenbemer, OWEB
 Marko Bey, Lomakatsi Restoration Project
 Mary Beth Smith, NRCS
 Matt Blakeley-Smith, Greenbelt Land Trust
 Matt Shelby, Oregon Lottery
 Melaney Dunne, Coquille Watershed Association
 Michelle Delepin, West Multnomah SWCD
 Nancy Bush, Clackamas County Disaster Management
 Nellie McAdams, Columbia Land Trust
 Nick Haxton, Oregon DEQ
 Nick Sirovatka, USDA-NRCS
 Nicole Ruggiero, Tualatin SWCD
 Nicole Maness, Willamette Partnership

Pat Holliday, Grant Soil & Water Conservation District
 Pat McAbery, Gresham Fire & Emergency Services
 Patricia Hickey, Washington Association of CDs
 Paul DeMaggio, PE, CAIS, CID, Jackson SWCD
 Pete Schreder, Oregon State University
 Rachel E. Wheat, Oregon Department of Fish and Wildlife
 Ray Brunner, Institute for Natural Resources
 Reed Warner, Oregon Watershed Enhancement Board
 Renee Davis, OWEB
 Robert Wallace, WyEast RC&D
 Robyn Pepin, Aspect Consulting
 Russ Lane, Oregon Department of Forestry
 Ryan Cahill, U.S. Army Corps of Engineers
 Ryan Gordon, Oregon Department of Forestry
 Sandi Hiatt, ODA
 Sarah Beaubien, Tillamook Dairy Co-op
 Sara Christensen, Oregon DEQ
 Scott Lightcap, BLM
 Scott West, OR Dept of Forestry
 Shilah Olson, Wasco County SWCD
 Stan Dan, Jackson SWCD
 Sue Greer, OWEB
 Sunny Summers, ODA
 Tara Choate, OWEB
 Teresa Matteson, Benton SWCD
 Tom Kaye, Institute for Applied Ecology
 Tom Thomson, NW Ag Consulting
 Torri Estrada, Carbon Cycle Institute

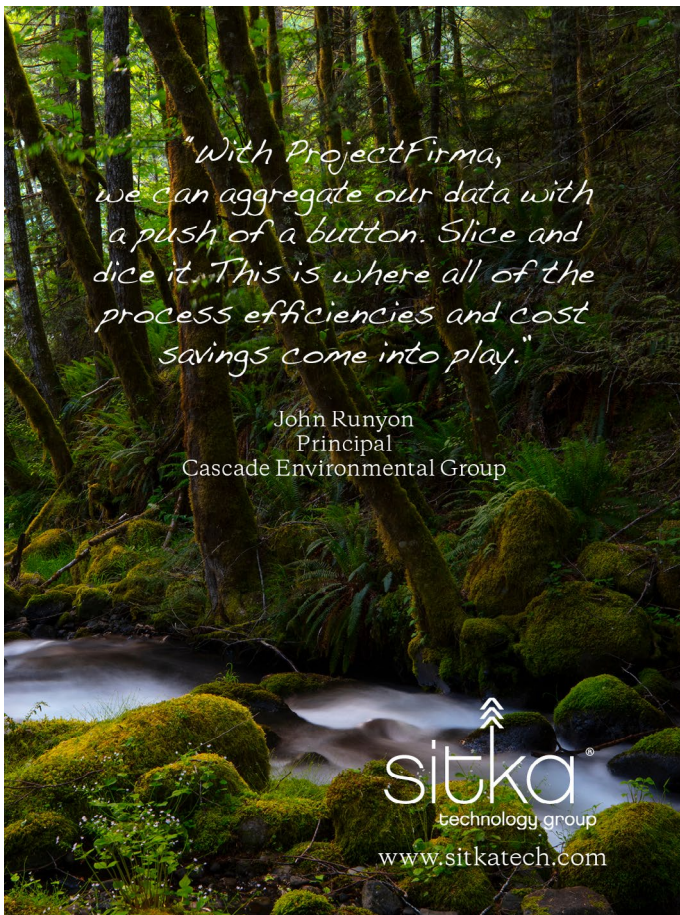

THANK YOU TO OUR SPONSORS

Ambassador Sponsors



**United States
Department of
Agriculture**

Natural Resources Conservation Service



Oregon
Conservation
Partnership



Wetland Sponsors



Tributary Sponsor

Oregon Department of Environmental Quality
Lower Columbia Engineering

Snack Sponsor

Sitka Technology Group

Session Sponsors

Tualatin SWCD
Clackamas SWCD

Scholarship Sponsors

Special Districts Insurance Services
Tualatin SWCD
Idaho Power
Wolf Water Resources